

NORTH YORKSHIRE COUNCIL  
(TEMPORARY PROHIBITION OF PEDESTRIANS)  
PUBLIC FOOTPATH 15.54/76/1, PANNAL AND BURN BRIDGE  
ORDER 2022 NO 203  
Road Traffic Regulation Act 1984 – Section 14(1) (as amended)

**NOTICE** is hereby given that the above Order, the effect of which is to prohibit any public access along Public Footpath 15.54/76/1 in the Parish of Pannal and Burn Bridge, between grid reference SE 29825257 and SE29865251 to ensure public safety during civil engineering works has been continued in force for a further twelve months until 11<sup>th</sup> January 2025 or until the completion of the works (whichever is the earlier), under Section 15(3) of the above Act with the approval of the Secretary of State for Transport.

The further continuation of the closure will be put into effect by notices and signs. An alternative route will be signed on site.

**All enquiries to:** Kevin Atkinson [Kevin@newetthomes.co.uk](mailto:Kevin@newetthomes.co.uk)

Further details can be viewed at: <https://www.northyorks.gov.uk/rights-way-public-notice>

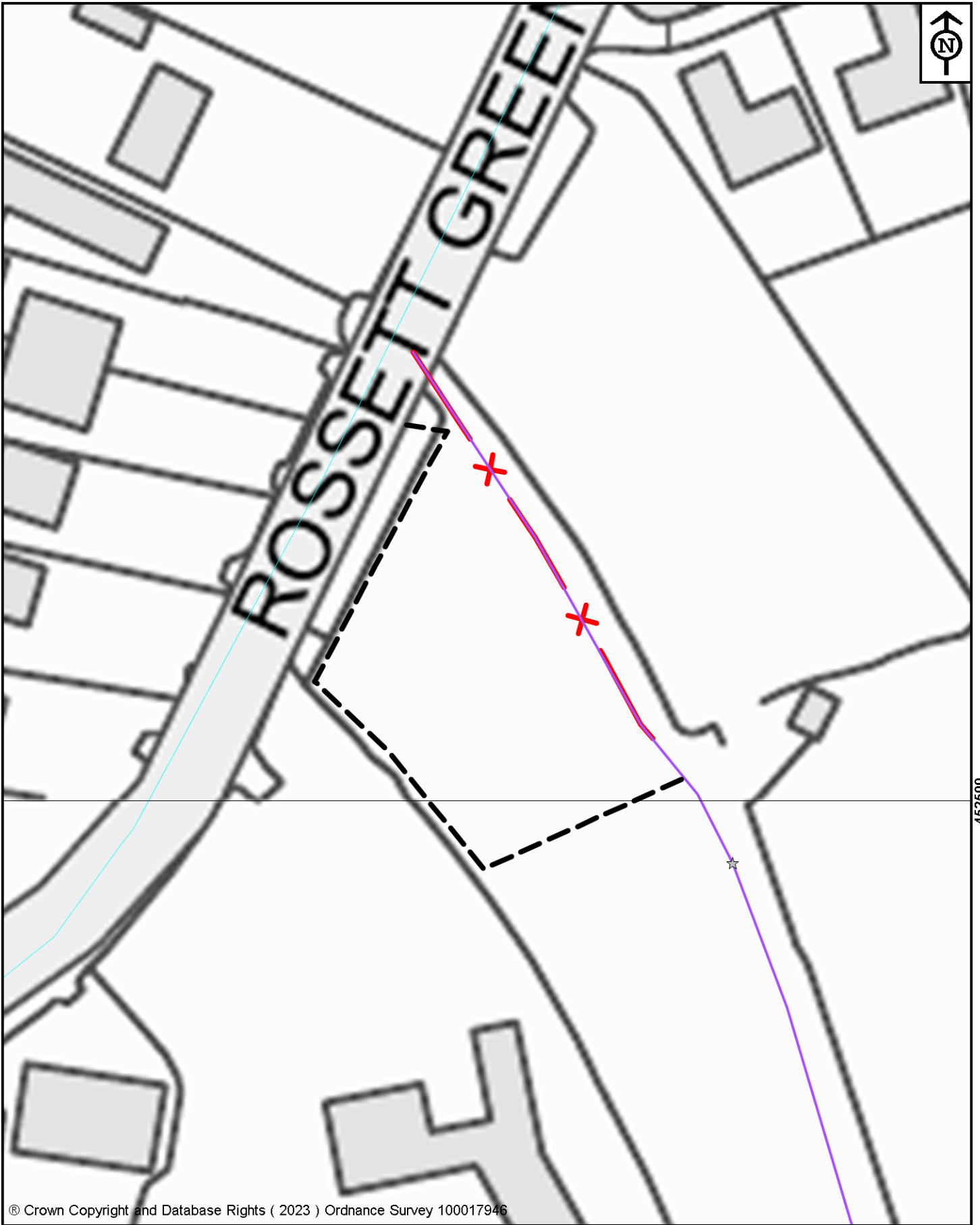

© Crown Copyright and Database Rights ( 2023 ) Ordnance Survey 100017946



**NORTH YORKSHIRE COUNCIL**  
 Public Rights of Way  
 Countryside Access Service  
 County Hall  
 Northallerton  
 DL7 8AH

Key:  
 Closed route  
 Alternative route  
 Public Footpath

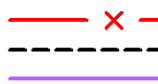

**The North Yorkshire Council**

Temporary closure of  
 Public Footpath 15.54/76/1 in  
 Pannal and Burn Bridge

Map drawn on 4 July 2023

Drawn by RL

Scale 1:750

File Ref No. 76/15/54/76/1