

NORTH YORKSHIRE COUNTY COUNCIL
(TEMPORARY PROHIBITION OF PEDESTRIANS)
PUBLIC FOOTPATHS 35.40/10/1, 35.40/9/2, KELFIELD AND 35.53/2/1, RICCALL
ORDER 2022 NO 122
Road Traffic Regulation Act 1984 – Section 14(1) (as amended)

NOTICE is hereby given that the above Order, the effect of which is to prohibit any public access along Public Footpaths 35.40/10/1, 35.40/9/2 Kelfield and 35.53/2/1, Riccall, between grid reference SE60583832 and SE60993760 due to public health and safety reasons while works are being carried out on the embankment has been continued in force for a further twelve months until 4th November 2023 or until the completion of the works (whichever is the earlier), under Section 15(3) of the above Act with the approval of the Secretary of State for Transport.

The further continuation of the closure will be put into effect by notices and signs.

All enquiries to: SUNOW Asset Performance Team Environment Agency Tel- 03708 506506

Further details can be viewed at: <https://www.northyorks.gov.uk/rights-way-public-notice>

Dated: 3rd November 2022

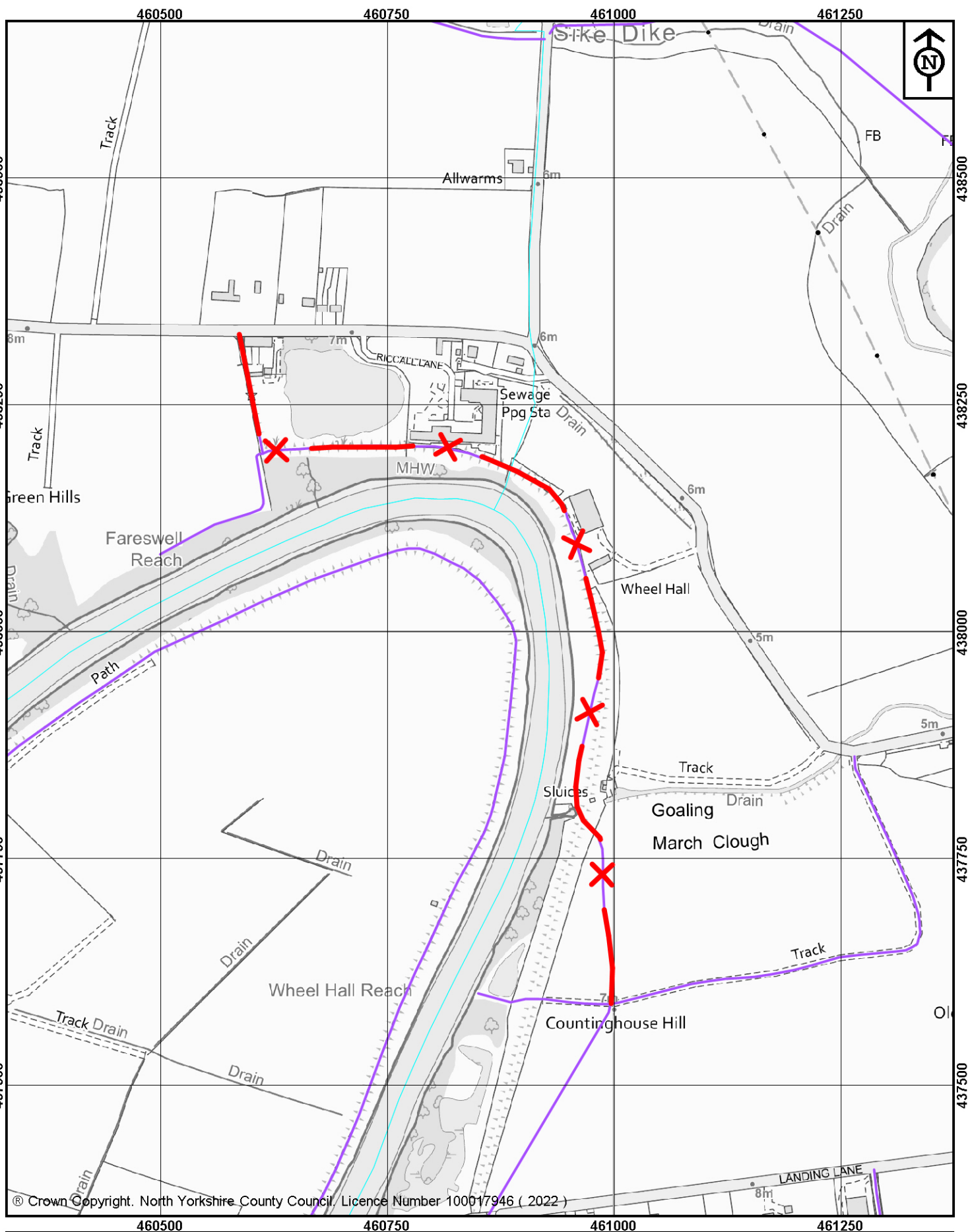

 <p>North Yorkshire County Council</p> <p>Public Rights of Way Waste and Countryside Services County Hall Northallerton DL7 8AH</p>	<p>Key:</p> <p>Closed route — X —</p> <p>Public Footpath —</p>	<p>North Yorkshire County Council</p> <p>Temporary closure of Public Footpath 35.40/10/1, 35.40/9/2 & 35.53/2/1 in Kelfield & Riccall</p>
	<p>Map drawn on 5 May 2022</p> <p>Drawn by AA Scale 1:5500</p>	