

# Memo

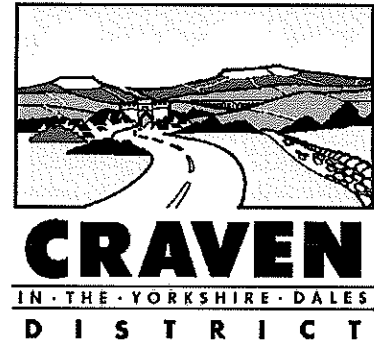

**To:** Samantha Platt, Assistant Trees Officer  
**From:** Alicia Hellawell  
**CC:** Joanne Boshier-Norcliffe – Local Land Charges Officer;  
**Ref:** LL/  
**Date:** 26<sup>th</sup> November 2014  
**Re:** **Tree Preservation Order No 225, 2014 (Elslack Parish)**

---

I enclose, for your records, a copy of the above Order which relates to a tree at Mill Cottage, Moor Lane, Elslack. I also enclose a copy of the formal notice of the making of the Order.

The Order is effective from 26<sup>th</sup> November 2014

A copy has been served on the following:

Mr R L Ingham and Ms E L Ingham  
Mill Cottage  
Moor Lane  
Elslack  
Skipton  
North Yorkshire  
BD23 3BB

Please let me know if you need any further information.

|                                     |      |
|-------------------------------------|------|
| CRAVEN DISTRICT COUNCIL<br>RECEIVED |      |
| 26 NOV 2014                         |      |
| Planning & Building Control         |      |
| Officer Dealing                     |      |
| Replied                             | File |



**CRAVEN DISTRICT COUNCIL**

**Elslack Parish**

**TREE PRESERVATION ORDER  
No. 225 2014**

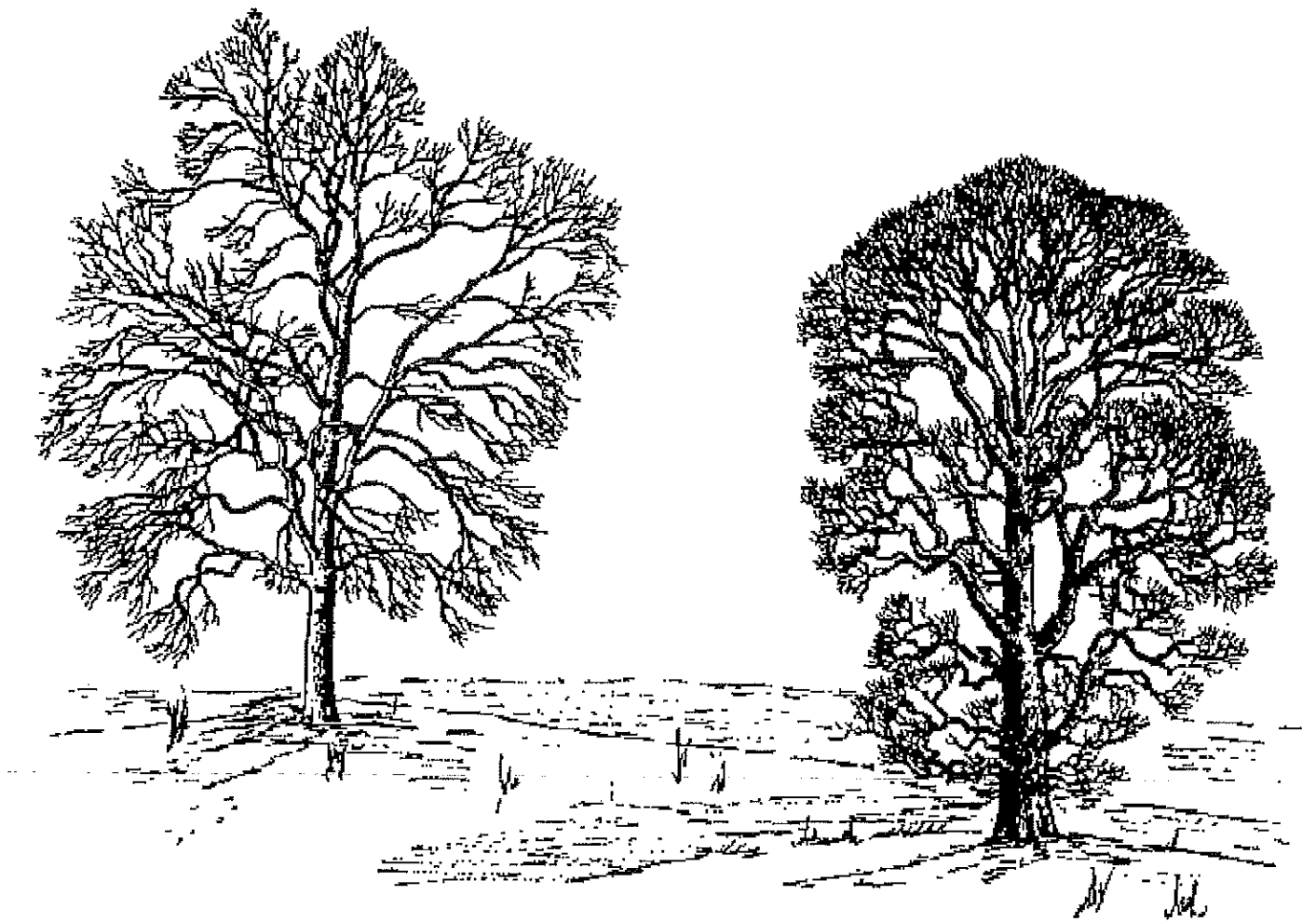





**Town and Country Planning Act 1990**  
**The Craven District Council Tree Preservation Order No 225, 2014**  
**Elslack Parish**

Craven District Council in exercise of the powers conferred on them by sections 198 of the Town and Country Planning Act 1990 hereby make the following Order-

**Citation**

1. This Order may be cited as the Craven District Council Tree Preservation Order No 225, 2014 (Elslack Parish)

**Interpretation**

2. (1) In this Order "the authority" means Craven District Council.

(2) In this Order any reference to a numbered section is a reference to the section so numbered in the Town and Country Planning Act 1990 and any reference to a numbered regulation is a reference to the regulation so numbered in the Town and Country Planning (Tree Preservation)(England) Regulations 2012.

**Effect**

3. (1) Subject to article 4, this Order takes effect provisionally on the date on which it is made.

(2) Without prejudice to subsection (7) of section 198 (power to make tree preservation orders) or subsection (1) of section 200 (tree preservation orders: Forestry Commissioners) and, subject to the exceptions in regulation 14, no person shall-

(a) cut down, top, lop, uproot, wilfully damage or wilfully destroy; or

(b) cause or permit the cutting down, topping, lopping, wilful damage or wilful destruction of,

any tree specified in the Schedule to this Order except with the written consent of the authority in accordance with regulations 16 and 17, or of the Secretary of State in accordance with regulation 23, and, where such consent is given subject to conditions, in accordance with those conditions.

**Application to trees to be planted pursuant to a condition**

4. In relation to any tree identified in the first column of the Schedule by the letter "C", being a tree to be planted pursuant to a condition imposed under paragraph (a) of section 197 (planning permission to include appropriate provision for preservation and planting of trees), this Order takes effect as from the time when the tree is planted.

Dated this 26<sup>th</sup> day of November 2014

The Common Seal of  
Craven District Council  
was hereunto affixed  
in the presence of -

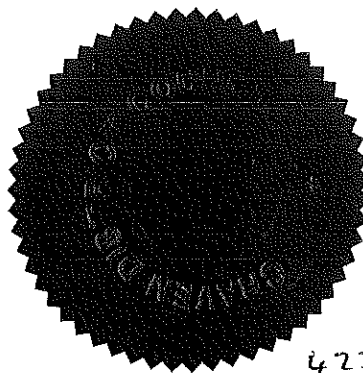

4229

*Ray Sherz*

Chief Executive



## SCHEDULE specification of trees

Trees specified individually  
(encircled in black on map)

| <u>No on Map</u> | <u>Description</u> | <u>Situation</u>          | <u>Map Reference</u> |
|------------------|--------------------|---------------------------|----------------------|
| T1               | Copper Beech       | shown on the attached map | SD 9352 4899         |
| T2               | Ash                | shown on the attached map | SD 9352 4899         |
| T3               | Sycamore           | shown on the attached map | SD 9352 4899         |
| T4               | Sycamore           | shown on the attached map | SD 9352 4897         |
| T5               | Sycamore           | shown on the attached map | SD 9357 4894         |
| T6               | Oak                | shown on the attached map | SD 9356 4896         |
| T7               | Sycamore           | shown on the attached map | SD 9356 4897         |
| T8               | Rowan              | shown on the attached map | SD 9356 4898         |

Trees specified by reference to an area  
(within dotted black line on map)

NONE

Groups of Trees  
(within broken black line on map)

| <u>No on Map</u> | <u>Description</u>   | <u>Situation</u>          | <u>Map Reference</u> |
|------------------|--|---------------------------|----------------------|
| G1               | 1 Ash<br>9 Alder (A)<br>1 Oak (O)<br>7 Sycamore (S)<br>1 Rowan (R) | shown on the attached map | SD 9354 4895         |

Woodlands  
(within continuous black line on map)

NONE





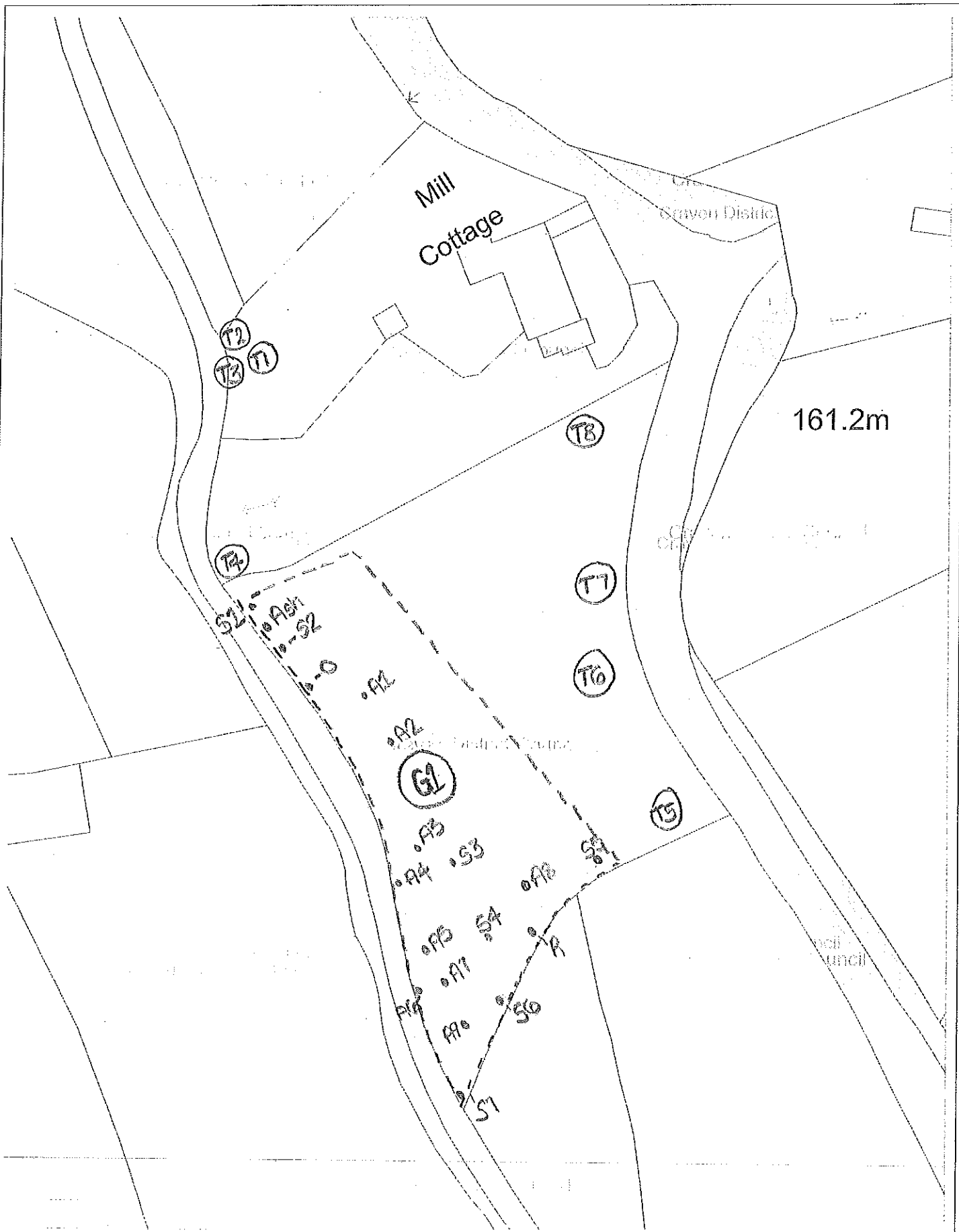

## TPO 225 2014

Mill Cottage, Elslack, BD23 3BB

SCALE : 1:500

Based on Ordnance Survey Mapping

© Crown Copyright and database right 2011. Ordnance Survey 100024694.

Drawing Issued By: S Bibby  
28th May 2014





## **IMPORTANT – THIS COMMUNICATION MAY AFFECT YOUR PROPERTY**

TOWN AND COUNTRY PLANNING ACT 1990

TOWN AND COUNTRY PLANNING (TREE PRESERVATION) (ENGLAND) REGULATIONS 2012

### **THE CRAVEN DISTRICT COUNCIL TREE PRESERVATION ORDER NO 225 2014 – ELSLACK PARISH**

THIS IS A FORMAL NOTICE to let you know that on 26<sup>th</sup> November 2014 Craven District Council made the above tree preservation order.

A copy of the order is enclosed. In simple terms, it prohibits anyone from cutting down, uprooting, damaging, destroying, topping or lopping any of the trees described in the Schedule and shown on the map without the Council's consent. Anyone who carries out works prohibited by the order is guilty of an offence and can be fined up to £20,000 by a Magistrates' Court (for each tree affected). Unlimited fines can be imposed by the Crown Court.

The Council have made the order because it is considered that the trees contribute significantly to the visual amenity of the area, and they should be retained and protected during any development of the adjacent property and for the future. Their location associated with Elslack beck is a good biodiversity habitat.

The order takes effect, on a provisional basis, on 26<sup>th</sup> November 2014. It will continue in force on this basis for 6 months or until the order is confirmed by the Council, whichever first occurs.

The Council will consider whether the order should be confirmed, that is to say, whether it should take effect permanently. Before this decision is made, the people affected by the order have a right to make objections or other representations about any of the trees, groups of trees or woodlands covered by the order.

If you would like to make any objections or other comments, please make sure the Council receives them in writing by 24<sup>th</sup> December 2014. Your comments must comply with regulation 6 of the Town and Country Planning (Tree Preservation) (England) Regulations 2012, a copy of which is provided overleaf. Send your comments to the Council's Planning Services department at the address below. All valid objections or representations are carefully considered before a decision on whether to confirm the order is made.

The Council will write to you again when that decision has been made. In the meantime, if you would like any further information or have any questions about this letter, please contact the Council's Trees Officer on 01756 706265.

Dated: 26<sup>th</sup> November 2014

Ian Swain  
Development Control Manager

Planning Services  
Craven District Council  
1 Belle Vue Square  
Broughton Road  
SKIPTON  
BD23 1FJ

**COPY OF REGULATION 6 OF THE  
TOWN AND COUNTRY PLANNING (TREE PRESERVATION) (ENGLAND)  
REGULATIONS 2012**

**Objections and representations**

6(1) *Subject to paragraph (2), objections and representations-*

*(a) shall be made in writing and-*

*(i) delivered to the authority not later than the date specified by them under regulation 5(2)(c); or*

*(ii) sent to the authority in a properly addressed and pre-paid letter posted at such time that, in the ordinary course of post, it would be delivered to them not later than that date;*

*(b) shall specify the particular trees, groups of trees or woodlands (as the case may be) in respect of which the objections or representations are made; and*

*(c) in case of an objection, shall state the reasons for the objection.*

6(2) *The authority may treat as duly made objections and representations which do not comply with the requirements of paragraph (1) if, in the particular case, they are satisfied that compliance with those requirements could not reasonably have been expected.*