

PRESS NOTICE

Notice of Confirmation of a Public Path Diversion and Definitive Map and Statement Modification Order Highways Act 1980 & Wildlife and Countryside Act 1981 The North Yorkshire Council Public Footpath No. 35.57/37, Eversley Park Centre Car Park, Sherburn in Elmet, Diversion Order 2023.

The above Order made under Section 119 of the Highways Act 1980 and Section 53A(2) of the Wildlife and Countryside Act 1981 was confirmed on 20.10.2023. The effect of the Order as confirmed is to divert the Public Footpath as follows: Public Footpath No. 35.57/37 - From GR SE 4942 3340 off Low St to GR SE 4940 3339 in Eversley Park Centre Car Park will be diverted onto a new line from GR SE 4943 3338 off Low St to GR SE 4940 3339.

A copy of the order as confirmed and the Order Map may be seen free of charge during normal office hours at Sherburn and Villages Community Library, Finkel Hill, Sherburn in Elmet, North Yorkshire until 21.12.2023. Copies of the Order and Map may be purchased from Countryside Access Service, North Yorkshire Council, County Hall, Northallerton, North Yorkshire, DL7 8AD (tel: 0300 1312131) at a cost of £2, or can be downloaded free from our website <https://www.northyorks.gov.uk/pathnotices>.

The Order comes into force on the date on which the Authority certifies, in accordance with Section 119(3)(b) of the 1980 Act, that work to the new section of path, described in Part 2 of the Schedule, has been completed, but if a person aggrieved by the Order wants to question its validity, or that of any provision contained in it, on the ground that it is not within the powers of the Highways Act 1980 as amended, or on the ground that any requirement of the Act, as amended, or of any regulation made under the Act has not been complied with in relation to the Order, he or she may, under Paragraph 2 of Schedule 2 to the Act as applied by Paragraph 5 of Schedule 6 to the Act, within six weeks from 9.11.2023, make an application to the High Court. Dated: 9.11.2023 Barry Khan, Assistant Chief Executive, (Legal and Democratic Services)

**PUBLIC PATH DIVERSION AND
DEFINITIVE MAP AND STATEMENT MODIFICATION ORDER**

HIGHWAYS ACT 1980

WILDLIFE AND COUNTRYSIDE ACT 1981

THE NORTH YORKSHIRE COUNCIL

**PUBLIC FOOTPATH NO. 35.57/37, EVERSLEY PARK CENTRE CAR
PARK, SHERBURN IN ELMET, DIVERSION ORDER 2023**

Barry Khan
Assistant Chief Executive
(Legal and Democratic Services)
County Hall
Northallerton
DL7 8AH

**PUBLIC PATH DIVERSION AND
DEFINITIVE MAP AND STATEMENT MODIFICATION ORDER**

HIGHWAYS ACT 1980

WILDLIFE AND COUNTRYSIDE ACT 1981

THE NORTH YORKSHIRE COUNCIL

**PUBLIC FOOTPATH NO. 35.57/37, EVERSLEY PARK CENTRE CAR PARK,
SHERBURN IN ELMET, DIVERSION ORDER 2023**

This Order is made by The North Yorkshire Council ("the Authority") under Section 119 of the Highways Act 1980 ("the 1980 Act") because it appears to the Authority that in the interests of the owner of the land crossed by the Public Footpath described in Paragraph 1 of this Order it is expedient that the line of the Path should be diverted.

This Order is also made under Section 53A(2) of the Wildlife and Countryside Act 1981 ("the 1981 Act") because it appears to the authority that The Former West Riding Of Yorkshire Area 2 Definitive Map and Statement require modification in consequence of the occurrence of an event specified in Section 53(3)(a)(i) of the 1981 Act, namely, the diversion (as authorised by this Order) of a highway shown or required to be shown in the map and statement.

Sherburn in Elmet Town Council, Council Offices, Eversley Park Centre, Sherburn in Elmet, Leeds, LS25 6BA has agreed to defray any compensation which becomes payable in consequence of the coming into force of this Order and any expenses which are incurred in bringing the new site of the Path into a fit condition for use by the public.

Sherburn In Elmet Parish Council have been consulted as required by Section 120(2) of the 1980 Act.

BY THIS ORDER:

1. The public right of way over the land situated at Eversley Park Centre Car Park, Sherburn In Elmet and shown by a bold continuous line on the map contained in this Order and described in Part 1 of the Schedule to this Order shall be stopped up on the date on which the Authority certifies, in accordance with Section 119(3)(b) of the 1980 Act, that work to the new section of path, as described in Part 2 of the Schedule, has been completed to the reasonable satisfaction of the Authority and thereupon The Former West Riding Of Yorkshire Area 2 Definitive Map shall be modified by deleting from it that public right of way. Under no circumstances shall such certification be given before the date of confirmation of this Order.
2. There shall from the date of the above mentioned certification be a Public Footpath over the land situated at Eversley Park Centre Car Park, Sherburn In Elmet described in Part 2 of the Schedule to this Order and shown by a bold broken line on the map contained in this Order and thereupon The Former West Riding Of Yorkshire Area 2 Definitive Map shall be modified by adding a Public Footpath to it.
- 2A. The Former West Riding Of Yorkshire Area 2 Definitive Statement shall be modified as described in Part 4 of the Schedule to this Order.
3. The rights conferred on the public under this Order shall be subject to the limitations and conditions set out in Part 3 of the Schedule.

THE COMMON SEAL of THE NORTH
YORKSHIRE COUNCIL

was hereunto affixed this 29TH day
of AUGUST 2023
in the presence of:-



**AUTHORISED
SIGNATORY**



SCHEDULE

PART 1

DESCRIPTION OF SITE OF EXISTING PUBLIC FOOTPATH

<u>Section of Footpath as shown on the attached map</u>	<u>Position</u>	<u>Width</u>
Public Footpath No. 35.57/37 as marked with a bold continuous line (A - B) on the attached plan.	Commences off Low Street at Grid Reference 44942 43340 (Point A) and runs west south west for approximately 28 metres to Grid Reference 44940 43339 (Point B) in the Eversley Park Centre Car Park.	1.5 Metres

PART 2

DESCRIPTION OF SITE OF NEW PUBLIC FOOTPATH

<u>Section of Footpath as shown on the attached map</u>	<u>Position</u>	<u>Width</u>
Public Footpath No. 35.57/37 as marked with a bold dashed line (C - D - B) on the attached plan	Commences off Low Street at Grid Reference 44942 43338 (Point C) at a gap in the wall and then continues west, along the boundary of the Eversley Park Centre Car Park for approximately 28 metres to Grid Reference 44940 43338 (Point D), where the path runs north, continuing along the car park boundary for approximately 10 metres to Grid Reference 44940 43339 (Point B), in the corner of the Eversley Park Centre Car Park. Total length of approximately 38 metres on a tarmac surface.	2 Metres

PART 3

LIMITATIONS AND CONDITIONS

<u>Position on Footpath to which limitations and conditions apply</u>	<u>Limitations and Conditions</u>
Grid Reference 44942 43338 (Point C)	Gap to BS5709:2018

PART 4

MODIFICATION OF DEFINITIVE STATEMENT
VARIATION OF PARTICULARS OF PATH OR WAY

Path No.	Grid Reference End Points	Description	Nature of Surface	Length (Km)	Width (m)	Lawful Obstructions and Conditions
35.57/37	44942 43340 44942 43338 (Start)	Commences off Low Street GR 44942 43340 44942 43338 at a gap in the wall, and then continuing west, along the boundary of the Eversley Park Centre Car Park for approx 28 metres to GR 44940 43338, where the path runs north, continuing along the car park boundary for approximately 10 metres to GR 44940 43339, in the corner of the Eversley Park Centre Car Park. The path then proceeds westerly for approx 154 126 metres to GR 44926 43339 then generally north north westerly for approx 56 metres until it reaches the edge of the cricket pitch at GR 44925 43344. The route follows the perimeter of the cricket pitch running generally west north westerly for approximately 169 metres to GR 44915 43349 then generally north westerly for approximately 13 metres to GR 44914 43350. The route continues generally westerly for approximately 72 metres to GR 44907 43349 and then generally westerly for approx 107 metres to GR 44897 43349 then continues westerly for approx. 12 metres to GR 44896 43349. The route continues north westerly between two properties for approx 29 metres to GR 44894 43350 then west south westerly for 29	Tarmacadam	0.038	2.0	GR 44942 43338 - Gap
			Grass	0.154	1.5	
				0.126	1.5	
				0.417		
			Earth + Stone	0.041	1.5	

	To 44891 43350 (Finish)	metres to its junction with Church Hill at GR 44891 43350.	Tarmacadam	0.029 Total 0.0644 0.651	1.5	
--	-------------------------------	---	------------	--	-----	--

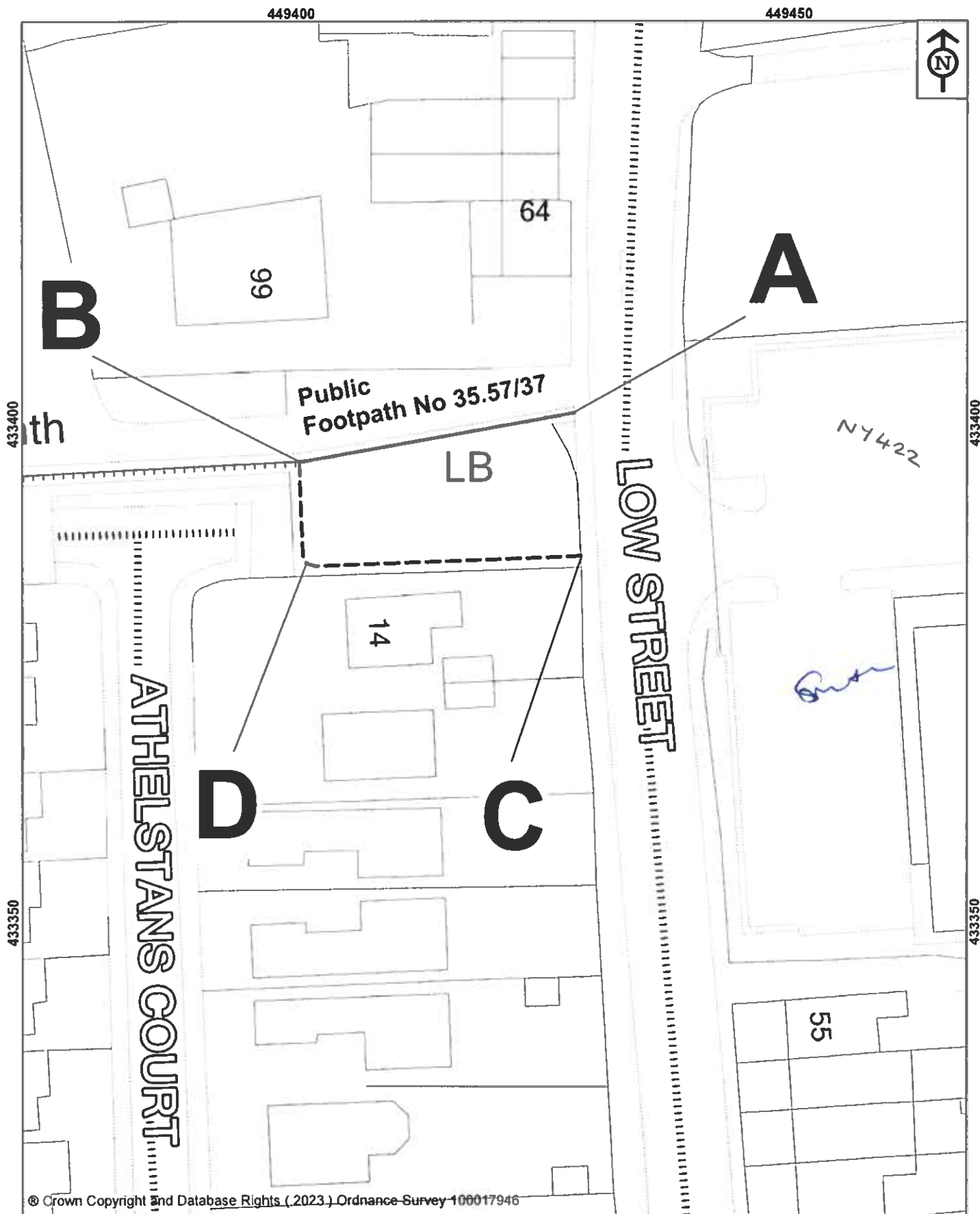

© Crown Copyright and Database Rights (2023) Ordnance Survey 100017946



**NORTH
YORKSHIRE
COUNCIL**

Public Rights of Way
Countryside Access Service
County Hall
Northallerton
DL7 8AH

Key:
Footpath to be added
Footpath to be deleted
Other footpaths
Maintainable Highways



Map drawn on 23 August 2023

Drawn by CP

Scale 1:500

The North Yorkshire Council
Highways Act 1980 Section 119
Wildlife & Countryside Act 1981

Public Footpath No. 35.57/37
Eversley Park Centre Car Park
Sherburn in Elmet
Diversion Order 2023

File Ref No. SEL/2023/01/DO

**PUBLIC PATH DIVERSION AND
DEFINITIVE MAP AND STATEMENT MODIFICATION ORDER**

HIGHWAYS ACT 1980

WILDLIFE AND COUNTRYSIDE ACT 1981

THE NORTH YORKSHIRE COUNCIL

**PUBLIC FOOTPATH NO. 35.57/37, EVERSLEY PARK CENTRE CAR PARK,
SHERBURN IN ELMET, DIVERSION ORDER 2023**

THE NORTH YORKSHIRE COUNCIL in exercise of the powers conferred upon it in that behalf hereby confirm the foregoing Order (without any modification) as an Unopposed Order.

IN WITNESS whereof
THE COMMON SEAL of THE NORTH
YORKSHIRE COUNCIL
was hereunto affixed this 20th day
of October 2023
in the presence of:-

M. Moore

**AUTHORISED
SIGNATORY**

