

SITE NOTICE

NOTICE OF MAKING OF A PUBLIC PATH DIVERSION ORDER AND DEFINITIVE MAP AND STATEMENT MODIFICATION ORDER

HIGHWAYS ACT 1980 WILDLIFE AND COUNTRYSIDE ACT 1981

THE NORTH YORKSHIRE COUNCIL THE PUBLIC FOOTPATHS 15.30/3, 15.30/4, 15.30/19 AND 15.30/20 DENTON RESERVE DENTON (MID-WHARFEDALE) DIVERSION ORDER 2025

The above Order, made on 18 March 2025, under Section 119 of the Highways Act 1980 and Section 53A(2) of the Wildlife and Countryside Act 1981, will divert the Public Footpaths described below.

Public Footpath 15.30/19 running from SE 1467 4994 to SE 1469 5011 to SE 1456 5014 to SE 1452 5040, (ABCD on the attached Plan), will be diverted onto new alignment starting at SE 1467 4994 proceeding to SE 1467 4999, over a culvert at SE 1466 4999, then via SE 1467 5011, SE 1456 5014 and SE 1458 5036 to SE 1452 5040 (AEFHCJD on the Plan). Also Footpath 15.30/20 running from SE 1546 5102 to SE 1546 5080 (WVU on the Plan) will be diverted onto a route from SE 1546 5102 over a culvert at SE 1549 5083 to SE 1547 5080 (WYX). Also Footpath 15.30/4 running between SE 1489 5020 through two walls to SE 1518 5007 and then to SE 1519 5009 (KLM), will be diverted onto a route from SE 1489 5021 to SE 1519 5009 on a track (NOM); and between SE 1523 5025 and SE 1549 5044 across a field (P-T) it will be diverted to run SE 1523 5025 to SE 1543 5024 to SE 1549 5044 on a track (PST). Also Footpath 15.30/3 running from SE 1550 5045 to SE 1549 5044 (R-Q) will be diverted to run SE 1550 5045 to SE 1549 5045 to SE 1549 5044 (RTQ); and from SE 1453 5083 to SE 1454 5084 to SE 1473 5083 (CC-BB-AA) it will be diverted to run SE 1453 5083 to SE 1454 5086 to SE 1454 5084 continuing via SE 1454 5086 to SE 1473 5083 (CC-FF-BB-EE-AA). The widths will be 2.5 metres and the surfaces will be grass, earth and crushed stone tracks.

A copy of the Order and the Order map have been placed and may be seen free of charge during normal office hours at Harrogate Library, Victoria Avenue, Harrogate HG1 1EG, North Yorkshire until 25 April 2025. Copies of the Order and map may be purchased from Countryside Access Services, North Yorkshire Council, County Hall, Northallerton, North Yorkshire, DL7 8AD (tel: 0300 131 2131) at a cost of £2 or can be downloaded free from our website www.northyorks.gov.uk/pathnotices

Any representations about, or objections to the Order may be sent in writing to Countryside Access Technical Officer, Definitive Map Team, North Yorkshire Council, Northallerton, North Yorkshire DL7 8AD or email Paths@northyorks.gov.uk not later than 25 April 2025. Please state the grounds on which they are made.

Please note that objections/representations cannot be treated as confidential and may come into the public domain. Copies of any objections or representations received may be disclosed to interested parties, including the Planning Inspectorate where the case is referred to it for determination.

If no such representations or objections are duly made, or if any so made are withdrawn, The North Yorkshire Council may confirm the Order as an unopposed Order. If the Order is sent to the Secretary of State for the Environment for confirmation, any representations and objections which have not been withdrawn will be sent with the Order.

Dated: 27 March 2025

Barry Khan
Assistant Chief Executive
(Legal and Democratic Services)
County Hall, Northallerton
North Yorkshire, DL7 8AH



**PUBLIC PATH DIVERSION AND
DEFINITIVE MAP AND STATEMENT MODIFICATION ORDER**

HIGHWAYS ACT 1980

WILDLIFE AND COUNTRYSIDE ACT 1981

THE NORTH YORKSHIRE COUNCIL

**THE PUBLIC FOOTPATHS 15.30/3, 15.30/4, 15.30/19 AND 15.30/20
DENTON RESERVE DENTON DIVERSION ORDER 2025**

Barry Khan
Assistant Chief Executive
(Legal and Democratic Services)
County Hall
Northallerton
DL7 8A

**PUBLIC PATH DIVERSION AND
DEFINITIVE MAP AND STATEMENT MODIFICATION ORDER**

HIGHWAYS ACT 1980

WILDLIFE AND COUNTRYSIDE ACT 1981

THE NORTH YORKSHIRE COUNCIL

**THE PUBLIC FOOTPATHS 15.30/3, 15.30/4, 15.30/19 AND 15.30/20 DENTON RESERVE
DENTON DIVERSION ORDER 2025**

This Order is made by The North Yorkshire Council ("the Authority") under Section 119 of the Highways Act 1980 ("the 1980 Act") because it appears to the Authority that in the interests of the public and the owner(s) of the land crossed by the Public Footpaths described in Paragraph 1 of this Order, it is expedient that the line of the Public Footpaths should be diverted.

This Order is also made under Section 53A(2) of the Wildlife and Countryside Act 1981 ("the 1981 Act") because it appears to the Authority that The Former West Riding Of Yorkshire Area 1 (outside Dales) Definitive Map and Statement require modification in consequence of the occurrence of an event specified in Section 53(3)(a)(i) of the 1981 Act, namely, the diversion (as authorised by this Order) of a highway shown or required to be shown in the map and statement.

The Denton Reserve, Home Farm, Denton, Ilkley LS29 0HF has agreed to defray any compensation which becomes payable in consequence of the coming into force of this Order and any expenses which are incurred in bringing the new site of the paths into a fit condition for use by the public.

Denton (now part of Mid Wharfedale) Parish Council has been consulted as required by Section 120(2) of the 1980 Act.

BY THIS ORDER:

1. The public rights of way over the land situated at Denton Reserve, Denton (mid Wharfedale) and shown by a bold continuous black line on the maps contained in this Order and described in Part 1 of the Schedule to this Order shall be stopped up on the date on which the Authority certifies, in accordance with Section 119(3)(b) of the 1980 Act, that work to the new sections of path, as described in Part 2 of the Schedule, has been completed to the reasonable satisfaction of the Authority. Under no circumstances shall such certification be given before the date of confirmation of this Order.
2. There shall from the date of the above-mentioned certification be Public Footpaths over the land situated at Denton Reserve, Denton (mid Wharfedale) described in Part 2 of the Schedule to this Order and shown by a bold broken black line on the maps contained in this Order.
3. The following works shall be carried out by the applicant in relation to the highways described in Part 2 of the Schedule: Provision of the Gates, Gaps and Culverts as specified in Part 3 of the Schedule to the Order below.
4. The rights conferred on the public under this Order shall be subject to the limitations and conditions set out in Part 3 of the Schedule.
5. Notwithstanding this Order Northern Powergrid shall have the following rights over the land referred to in Paragraph 1, namely:- The Statutory Rights of Northern Powergrid
6. The Former West Riding of Yorkshire Area 1 (outside Dales) Definitive Statement shall be modified as described in Part 4 of the Schedule to this Order.

THE COMMON SEAL of THE NORTH YORKSHIRE COUNCIL

was hereunto affixed this 18th

day of MARCH, 2025.

in the presence of:-

CLD



SCHEDULE

PART 1

DESCRIPTION OF SITE OF EXISTING PUBLIC FOOTPATHS

<u>Section of Public Footpath to be extinguished, shown on the attached Plan as a solid bold black line</u>	<u>Position</u>	<u>Width</u>
Footpath 15.30/19 A-B-C-D	Commencing at Grid Reference 41467 44994 (Point A) and proceeding generally east-north-eastwards for 168 metres through a wall to Grid Reference 41469 45011 (Point B) then continuing generally westwards for 134 metres through a gate at Grid Reference 41456 45014 (Point C) and proceeding north-westwards then and generally northwards for 282 metres to Grid Reference 41452 45040 (Point D), all on a grass surface	0.9 metres
Footpath 15.30/4 K-L-M	Commencing at Grid Reference 41489 45020 (Point K), its junction with UUR U2485/9 and proceeding south-eastwards for 322 metres through a wall and continuing to Grid Reference 41518 45007 (Point L), then continuing north-eastwards for 24 metres to Grid Reference 41519 45009 (Point M), on a grass surface	0.9 metres
Footpath 15.30/4 P-Q	Commencing at Grid Reference 41523 45025 (Point P) and proceeding north-eastwards for 328 metres to Grid Reference 41549 45044 (Point Q), its junction with Footpath 15.30/3, on a grass surface.	0.9 metres
Footpath 15.30/3 R-Q	Commencing at Grid Reference 41550 45045 (Point R) and proceeding south-westwards over a cattle grid for 9 metres to Grid Reference 41549 45044 (Point Q), its junction with Footpath 15.30/4 on a metalled surface	0.9 metres
Footpath 15.30/3 CC-BB-AA	Commencing at Grid Reference 41453 45083 (Point CC) and proceeding north-eastwards for 16 metres over a cattle grid to Grid Reference 41454 45084 (Point BB) and continuing generally eastwards for 192 metres through a tree-belt and fences to Grid Reference 41473 45083 (Point AA) on a grass and metalled surface	0.9 metres
Footpath 15.30/20 W-V-U	Commencing at Grid Reference 41546 45102 (Point W) and proceeding generally southwards for 135 metres to a gate at Grid Reference 41545 45090 (Point V), and continuing generally southwards for 120 metres to Grid Reference 41546 45080 (Point U) via a gate, its junction with Footpath 15.30/3, on a grass and metalled surface	0.9 metres

PART 2

DESCRIPTION OF SITE OF NEW PUBLIC FOOTPATHS

<u>Section of Public Footpath to be created, shown on the attached map by a bold black broken line</u>	<u>Position</u>	<u>Width</u>
Footpath 15.30/19 A-E-F-G-H-I-C-J-D	Commences at Grid Reference 41467 44994 (Point A) on grass and proceeds generally northwards for 47 metres approximately to Grid Reference 41467 44999 (Point E), continuing west for 11 metres approximately to cross a culvert at Grid Reference 41466 44999 (Point F) and turning northwards for 112 metres approximately passing through a gate at Grid Reference 41466 45001 (Point G), to reach Grid Reference 41467 45011 (Point H), all on grass; then proceeding generally west-northwestwards for 125 metres approximately on a stone track to pass through a Gap at Grid Reference 41457 45014 (Point I), then continuing west for 3 metres through a gate at Grid Reference 41456 45014 (Point C) and then north for 222 metres approximately to Grid Reference 41458 45036 (Point J) and generally northwestwards for 72 metres approximately to Grid Reference 41452 45040 (Point D), all on grass; a total distance of 592 metres approximately.	2.5 metres
Footpath 15.30/4 N-O-M	Commencing at a bend in the UUR U2485/9 at Grid Reference 41489 45021 (Point N) and proceeding generally southeastwards passing through a gate at Grid Reference 41504 45014 (Point O) to the north of a cattle-grid, and continuing generally southeastwards to Grid Reference 41519 45009 (Point M), a distance of 325 metres approximately on a stone track.	2.5 metres
Footpath 15.30/4 P-S-Q	Commencing at a bend on a stone track at Grid Reference 41523 45025 (Point P) to the north of a gate, and proceeding generally eastwards to Grid Reference 41543 45024 (Point S) and then generally northeastwards to Grid Reference 41549 45044 (Point Q), its junction with Footpath 15.30/3, a total distance of 420 metres approximately on a stone track.	2.5 metres
Footpath 15.30/3 R-T-Q	Commencing at Grid Reference 41550 45045 (Point R) at a stone track north of a cattle-grid, and proceeding generally southwestwards and then southeastwards through a gate at Grid Reference 41549 45045 (Point T) for 11 metres approximately to rejoin the stone track at Grid Reference 41549 45044 (Point Q), its junction with Footpath 15.30/4 on grass and earth.	2.5 metres

<p>Footpath 15.30/3 CC-FF-BB-EE-DD-AA</p>	<p>Commencing at a stone track at Grid Reference 41453 45083 (Point CC) and proceeds generally north for 15 metres on grass and earth through a gate to the west of a cattle-grid at Grid Reference 41453 45084 (Point FF) continuing generally northeastwards for 15 metres approximately to Grid Reference 41454 45084 (Point BB) on a stone track, then generally northeastwards on a stone track for 15 metres approximately to pass through a gate at Grid Reference 41454 45086 (Point EE), and continuing generally eastwards for 145 metres approximately to pass through a gate at Grid Reference 41469 45086 (Point DD), on a grass and earth track, then generally southeastwards on a grass and earth track for 55 metres approximately to Grid Reference 41473 45083 (Point AA), a distance of 245 metres approximately.</p>	<p>2.5 metres</p>
<p>Footpath 15.30/20 W-Z-Y-X</p>	<p>Commencing at Grid Reference 41546 45102 (Point W) on Footpath 15.30/20 to the south of a gate and proceeding generally southwards for 145 metres approximately through a gate at Grid Reference 41547 45088 (Point Z) then continuing southeastwards and then generally south for 52 metres approximately to cross a culvert at Grid Reference 41549 45083 (Point Y), and continuing uphill generally south and then southwestwards for 48 metres approximately through a gate to Grid Reference 41547 45080 (Point X), at a stone track, its junction with Footpath 15.30/3, a total distance of 245 metres approximately all on grass and earth.</p>	<p>2.5 metres</p>

PART 3

LIMITATIONS AND CONDITIONS

<u>Position on Footpaths to which limitations and conditions apply</u>	<u>Limitations and Conditions</u>
<u>Footpath 15.30/19</u>	
Grid Reference 41466 44999 (Point F)	Culvert with minimum width 2.5 metres
Grid Reference 41457 45014 (Point I)	Gap to BS5709:2018
Grid Reference 41466 45001 (Point G)	Pedestrian Gate to BS5709:2018 with width between 1.5 and 3.7 metres (Can be a field-gate)
Grid Reference 41456 45014 (Point C)	Pedestrian Gate to BS5709:2018 with width between 1.5 and 3.7 metres (Can be a field-gate)
<u>Footpath 15.30/4</u>	
Grid Reference 41504 45014 (Point O)	Pedestrian Gate to BS5709:2018 with width between 1.5 and 3.7 metres (Can be a field-gate)
<u>Footpath 15.30/20</u>	
Grid Reference 41547 45080 (Point X)	Pedestrian Gate to BS5709:2018 with width between 1.5 and 3.7 metres (Can be a field-gate)
Grid Reference 41549 45083 (Point Y)	Culvert with minimum width 2.5 metres
Grid Reference 41547 45088 (Point Z)	Pedestrian Gate to BS5709:2018 with width between 1.5 and 3.7 metres (Can be a field-gate)
<u>Footpath 15.30/3</u>	
Grid Reference 41549 45045 (Point T)	Pedestrian Gate to BS5709:2018 with width between 1.5 and 3.7 metres
Grid Reference 41469 45086 (Point DD)	Pedestrian Gate to BS5709:2018 with width between 1.5 and 3.7 metres
Grid Reference 41454 45086 (Point EE)	Pedestrian Gate to BS5709:2018 with width between 1.5 and 3.7 metres
Grid Reference 41453 45084 (Point FF)	Pedestrian Gate to BS5709:2018 with width between 1.5 and 3.7 metres (All can be a field-gates)

PART 4

MODIFICATION OF DEFINITIVE STATEMENT VARIATION OF PARTICULARS OF PATH OR WAY

Path No.	Grid Reference End Points	Description	Nature of Surface	Length (Km)	Width (m)	Lawful Obstructions and Conditions
Footpath 15.30/19	41462 44914 (Start) To 41449 45065 (Finish)	Starts on the County road west of Well House and proceeds northerly via Willow Hill to Grid Reference 41467 44994 on grass and proceeds generally northwards for 47 metres approximately to Grid Reference 41467 44999, continuing west for 11 metres approximately to cross a culvert at Grid Reference 41466 44999 and turning northwards for 112 metres approximately passing through a gate at Grid Reference 41466 45001, to reach Grid Reference 41467 45011, all on grass; then proceeding generally west-northwestwards for 125 metres approximately on a stone track to pass through a gap at Grid Reference 41457 45014, then continuing west for 3 metres through a gate at Grid Reference 41456 45014 and then north for 222 metres approximately to Grid Reference 41458 45036 and generally northwestwards for 72 metres approximately to Grid Reference 41452 45040 on grass, and proceeds northerly to its junction with path number 3	Pasture	1.695 0.822	0.9 0.9	Grid Reference 41466 44999 - Culvert Grid Reference 41466 45001 - Field Gate Field Gate Grid Reference 41457 45014 - Gap Grid Reference 41456 45014 - Field Gate Stile Field Gate
			Grass	0.170	2	
			Stone track	0.125	2	
			Grass	0.297	2	
			Pasture	0.289 (TOTAL 1.703)	0.9	
Footpath 15.30/4	41489 45021 (Start) To 41586 45027 (Finish)	Starts on the County road Commencing at a bend in the UUR U2485/9 east of Yarnett House at Grid Reference 41489 45021 and proceeding generally southeastwards passing through a gate at Grid Reference 41504 45014 to the north of a cattle-grid, and continuing generally southeastwards to Grid Reference 41519 45009, all on a stone track, a distance of 325 metres approximately and proceeds south easterly and then north northeasterly to a bend on a stone track at Grid Reference 41523 45025 to the north of a gate, proceeding generally eastwards to Grid Reference 41543 45024 and then generally northeastwards to Grid Reference 41549 45044 its junction with Footpath 15.30/3, on a stone track, a distance of 420 metres approximately then turns southeasterly to the Askwith Parish Boundary at Scales Gill	Grass	1.314 0.325	0.9 2	Grid Reference 41504 45014 - Field Gate Grid Reference 41523 45025 - Field Gate Field Gate Field Gate Field Gate Field Gate
			Stone track	0.325	2	
			Grass	0.175	0.9	
			Stone track	0.420	2	
			Grass	0.465 (TOTAL 1.385)	0.9	

Footpath 15.30/3	41412 45042 (Start) To 41549 45044 (Finish)	Starts on the County road north of Moor Side and proceeds northeasterly to a stone track at Grid Reference 41453 45083 and proceeds generally north for 15 metres on grass and earth through a gate to the west of a cattle-grid at Grid Reference 41453 45084 continuing generally northeastwards for 15 metres approximately to Grid Reference 41454 45084 on a stone track, then generally northeastwards on a stone track for 15 metres approximately to pass through a gate at Grid Reference 41454 45086, and continuing generally eastwards for 145 metres approximately to pass through a gate at Grid Reference 41469 45086, on a grass and earth track, then generally southeastwards on a grass and earth track for 55 metres approximately to Grid Reference 41473 45083, a total distance of 245 metres approximately, then proceeds northeasterly to Dunkirk and then turns southwesterly to Grid Reference 41550 45045 at a stone track north of a cattle-grid, and proceeding generally southwestwards and then southeastwards through a gate at Grid Reference 41549 45045 for 11 metres approximately to rejoin the stone track at Grid Reference 41549 45044, its junction with Footpath 15.30/4 on grass and earth.	Grass Grass and earth	2.076 0.625 0.015	0.9 2	Grid Reference 41549 45045 - Field Gate Grid Reference 41469 45086 - Field Gate Grid Reference 41454 45086 - Field Gate Gap Gap Gap Grid Reference 41453 45084 - Field Gate
			Stone track	0.030	2	
			Grass and earth	0.200	2	
			Grass	1.234	0.9	
			Grass and earth	0.011 (TOTAL 2.115)	2	
Footpath 15.30/20	41579 45214 (Start) To 41547 45080 (Finish)	Starts on the County road south of Ellercarr Pike and proceeds southwesterly via Cook Lakes continuing through a gate to Grid Reference 41546 45102 and proceeding generally southwards for 145 metres approximately through a gate at Grid Reference 41547 45088 then continuing southeastwards and then generally south for 52 metres approximately to cross a culvert at Grid Reference 41549 45083, and continuing uphill generally south and then southwestwards for 48 metres approximately through a gate to Grid Reference 41547 45080, at a stone track, its junction with Footpath 15.30/3, a distance of 245 metres approximately on grass and earth and Dunkirk	Moorland Grass and earth	1.430 1.175 0.245 (TOTAL 1.420)	0.9 2	Gate Gate Grid Reference 41547 45088 - Field Gate Grid Reference 41549 45083 - Culvert Grid Reference 41547 45080 - Field Gate

Plan 1

ORDNANCE SURVEY GRID REFERENCES

A = SE1467 4994
B = SE1469 5011
C = SE1456 5014
D = SE1452 5040
E = SE1467 4999
F = SE1466 4999
G = SE1466 5001
H = SE1467 5011
I = SE1457 5014
J = SE1458 5036
K = SE1489 5020
L = SE1518 5007
M = SE1519 5009
N = SE1489 5021
O = SE1504 5014

FOOTPATHS TO BE ADDED

N—O—M
and A—E—F—G—H
—I—C—J—D

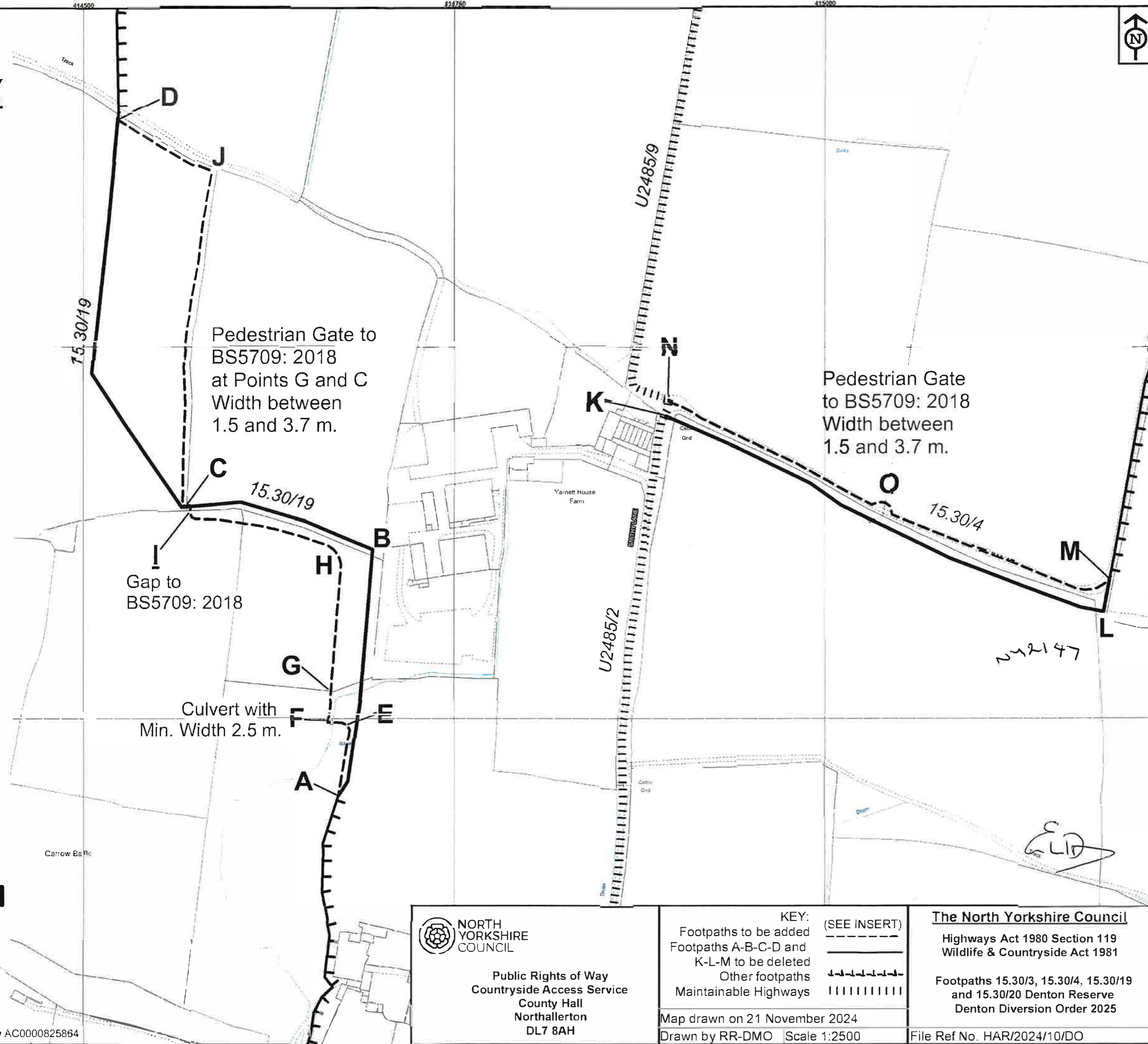

Public Rights of Way
Countryside Access Service
County Hall
Northallerton
DL7 8AH

KEY:
Footpaths to be added (SEE INSERT)
Footpaths A-B-C-D and K-L-M to be deleted
Other footpaths
Maintainable Highways

Map drawn on 21 November 2024
Drawn by RR-DMO Scale 1:2500

The North Yorkshire Council
Highways Act 1980 Section 119
Wildlife & Countryside Act 1981
Footpaths 15.30/3, 15.30/4, 15.30/19
and 15.30/20 Denton Reserve
Denton Diversion Order 2025

File Ref No. HAR/2024/10/DO

Plan 1

ORDNANCE SURVEY

GRID REFERENCES

A = SE1467 4994
 B = SE1469 5011
 C = SE1456 5014
 D = SE1452 5040
 E = SE1467 4999
 F = SE1466 4999
 G = SE1466 5001
 H = SE1467 5011
 I = SE1457 5014
 J = SE1458 5036
 K = SE1489 5020
 L = SE1518 5007
 M = SE1519 5009
 N = SE1489 5021
 O = SE1504 5014

FOOTPATHS TO BE ADDED

N—O—M
 and A—E—F—G—H
 |—I—C—J—D

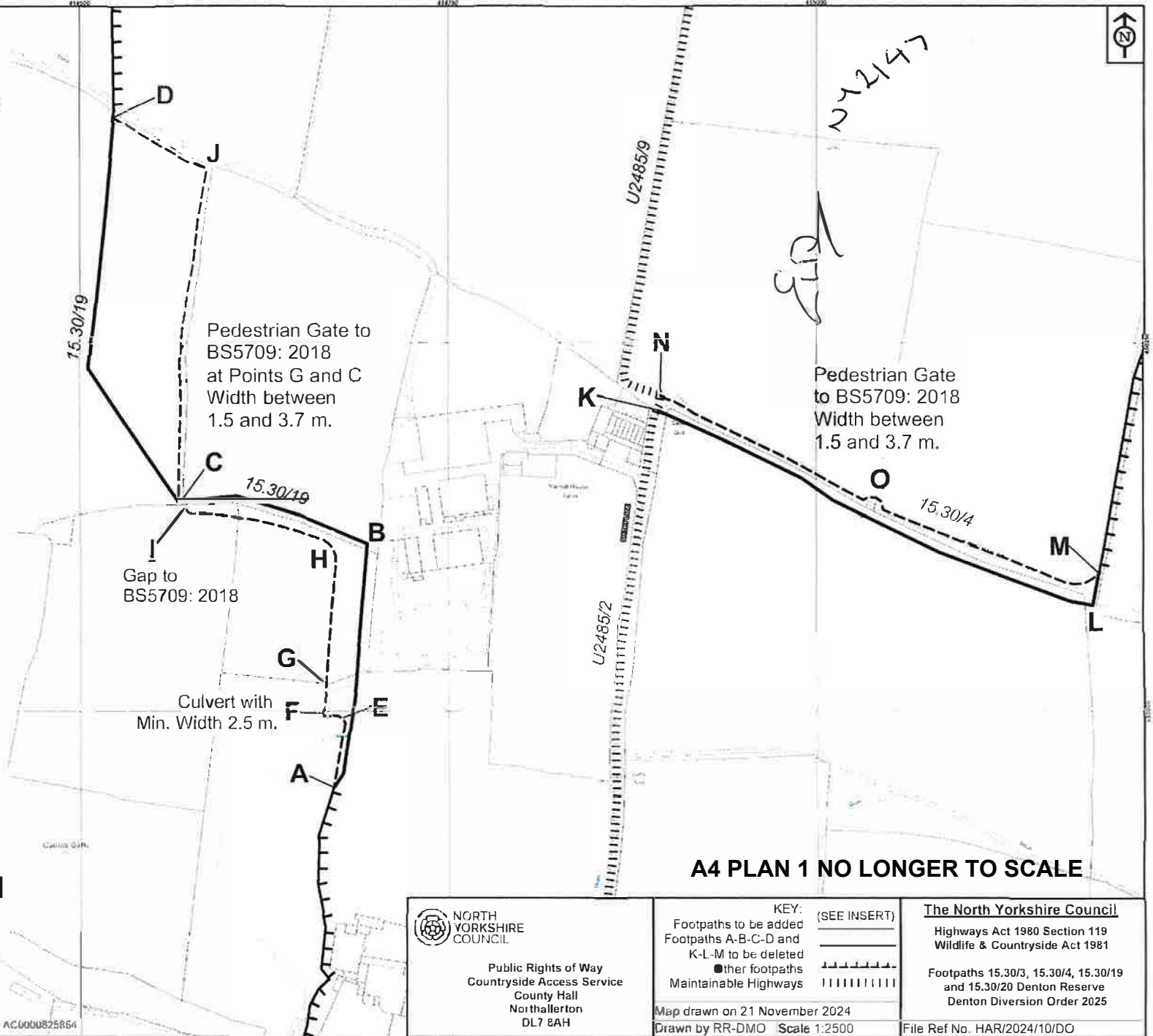

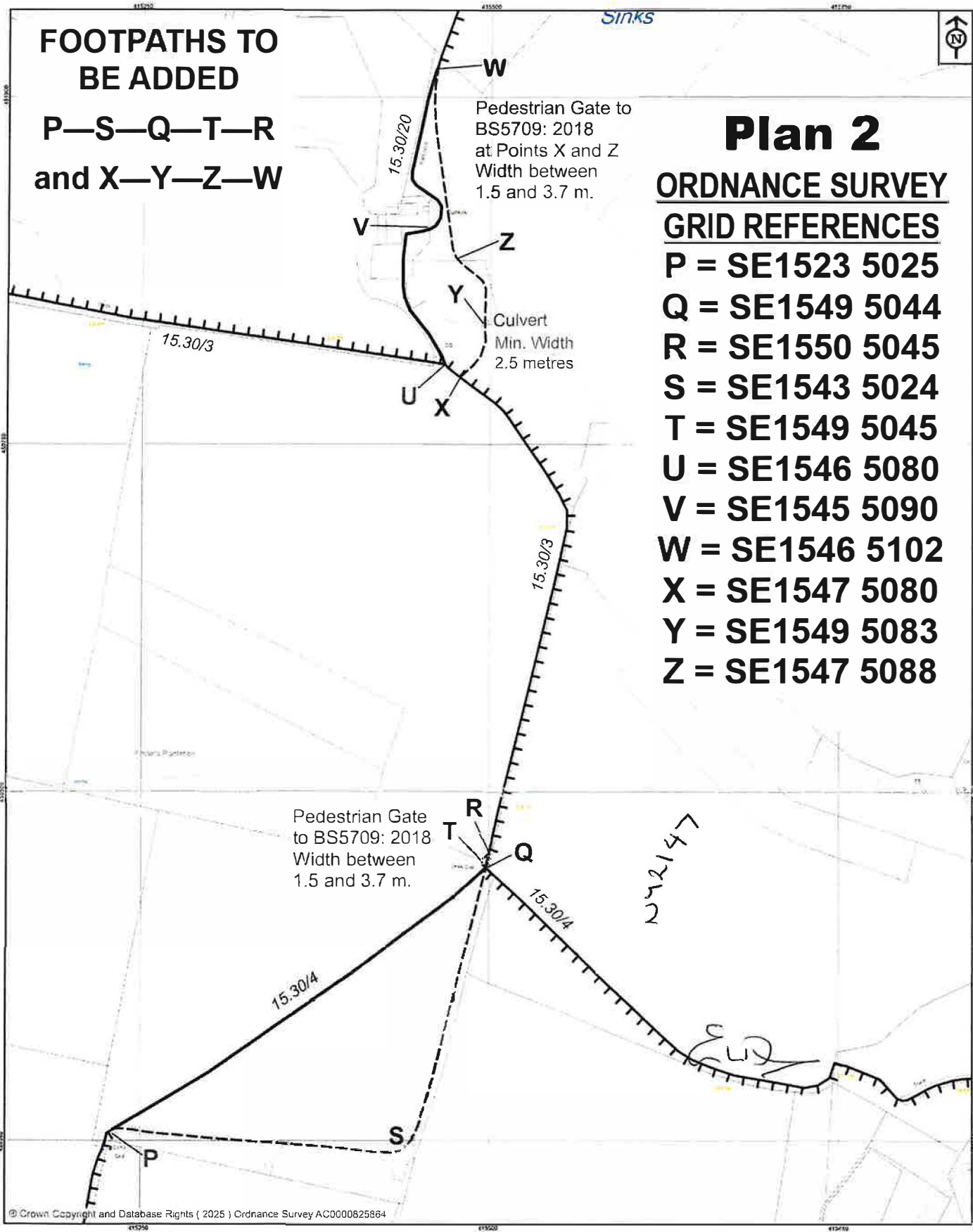

FOOTPATHS TO BE ADDED

P—S—Q—T—R
and X—Y—Z—W

Plan 2

ORDNANCE SURVEY

GRID REFERENCES

P = SE1523 5025
Q = SE1549 5044
R = SE1550 5045
S = SE1543 5024
T = SE1549 5045
U = SE1546 5080
V = SE1545 5090
W = SE1546 5102
X = SE1547 5080
Y = SE1549 5083
Z = SE1547 5088

Pedestrian Gate to BS5709: 2018
Width between 1.5 and 3.7 m.

Pedestrian Gate to BS5709: 2018
at Points X and Z
Width between 1.5 and 3.7 m.

Culvert
Min. Width 2.5 metres



NORTH YORKSHIRE COUNCIL
Public Rights of Way
Countryside Access Service
County Hall
Northallerton
DL7 8AH

KEY: (SEE INSERT)
Footpaths to be added -----
Footpaths P-Q-R and U-V-W to be deleted -----
Other footpaths -----
Maintainable Highways |||||

Map drawn on 21 November 2024
Drawn by RR-DMO Scale 1:2500

The North Yorkshire Council
Highways Act 1980 Section 119
Wildlife & Countryside Act 1981

Footpaths 15.30/3, 15.30/4, 15.30/19
and 15.30/20 Denton Reserve Denton
Diversion Order 2025

File Ref No. HAR/2024/10/DO

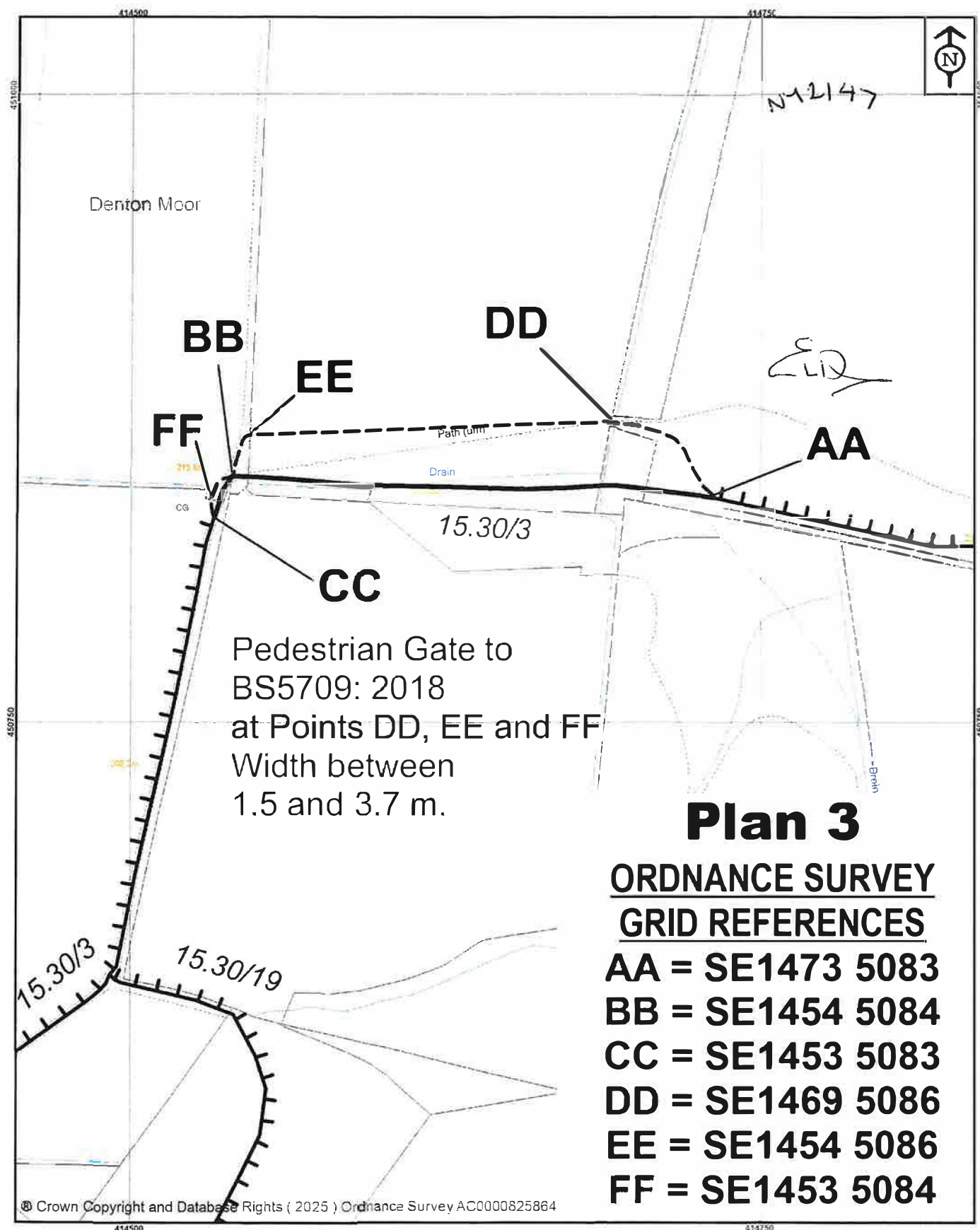

NORTH
YORKSHIRE
COUNCIL

Public Rights of Way
Countryside Access Service
County Hall
Northallerton
DL7 8AH

KEY:

Map drawn on 21 November 2024

Drawn by RR-DMO Scale 1:2000

The North Yorkshire Council

Highways Act 1980 Section 119
Wildlife & Countryside Act 1981

Footpaths 15.30/3, 15.30/4, 15.30/19
& 15.30/20 Denton Reserve Denton
Diversion Order 2025

File Ref No. HAR/2024/10/DO

