

SITE NOTICE

NOTICE OF CONFIRMATION OF A PUBLIC PATH DIVERSION ORDER AND DEFINITIVE MAP AND STATEMENT MODIFICATION ORDER

HIGHWAYS ACT 1980 WILDLIFE AND COUNTRYSIDE ACT 1981

THE NORTH YORKSHIRE COUNCIL

PUBLIC FOOTPATHS NOS 10.164/1 & 10.164/2, WRAY HOUSE, WELBURY DIVERSION ORDER 2025

The above Order made under Section 119 of the Highways Act 1980 and Section 53A(2) of the Wildlife and Countryside Act 1981, was confirmed on 15/04/2025.

The effect of the Order as confirmed is to divert the Public Footpaths as follows:

Public Footpath 10.164/1 between SE 3927 9965 and SE 3939 9969, via SE 3931 9967 will be diverted onto a new route between SE 3927 9965 and SE 3939 9969 via SE 3929 9964 and SE 3931 9962. Public Footpath 10.164/2 between SE 3937 9973 and SE 3931 9967 will be diverted onto a new route from SE 3937 9973 to SE 3939 9969.

A copy of the order as confirmed and the Order Map have been placed and may be seen free of charge during normal office hours at Northallerton Library, North Yorkshire until 06/06/2025. Copies of the Order and Map may be purchased from Countryside Access Services, North Yorkshire Council, County Hall, Northallerton, North Yorkshire, DL7 8AD (tel: 03001312131) at a cost of £2, or can be downloaded free from our website www.northyorks.gov.uk/pathnotices.

The Order comes into force on the date on which the Authority certifies, in accordance with Section 119(3)(b) of the 1980 Act, that work to the new section of path, described in Part 2 of the Schedule, has been completed, but if a person aggrieved by the Order wants to question its validity, or that of any provision contained in it, on the ground that it is not within the powers of the Highways Act 1980 as amended, or on the ground that any requirement of the Act, as amended, or of any regulation made under the Act has not been complied with in relation to the Order, he or she may, under Paragraph 2 of Schedule 2 to the Act as applied by Paragraph 5 of Schedule 6 to the Act, within six weeks from 25/04/2025, make an application to the High Court.

Dated 25/04/2025

Barry Khan
Assistant Chief Executive
(Legal and Democratic Services)
County Hall
Northallerton
North Yorkshire
DL7 8AH



**PUBLIC PATH DIVERSION AND
DEFINITIVE MAP AND STATEMENT MODIFICATION ORDER**

HIGHWAYS ACT 1980

WILDLIFE AND COUNTRYSIDE ACT 1981

THE NORTH YORKSHIRE COUNCIL

**PUBLIC FOOTPATHS NOS 10.164/1 & 10.164/2, WRAY HOUSE,
WELBURY DIVERSION ORDER 2025**

Barry Khan
Assistant Chief Executive
(Legal and Democratic Services)
County Hall
Northallerton
DL7 8AH

**PUBLIC PATH DIVERSION AND
DEFINITIVE MAP AND STATEMENT MODIFICATION ORDER**

HIGHWAYS ACT 1980

WILDLIFE AND COUNTRYSIDE ACT 1981

THE NORTH YORKSHIRE COUNCIL

**PUBLIC FOOTPATHS NOS 10.164/1 & 10.164/2, WRAY HOUSE, WELBURY DIVERSION
ORDER 2025**

This Order is made by The North Yorkshire Council ("the Authority") under Section 119 of the Highways Act 1980 ("the 1980 Act") because it appears to the Authority that in the interests of the public it is expedient that the line of the Public Footpaths should be diverted.

This Order is also made under Section 53A(2) of the Wildlife and Countryside Act 1981 ("the 1981 Act") because it appears to the Authority that The District of Hambleton (outside The North York Moors National Park) Definitive Map and Statement require modification in consequence of the occurrence of an event specified in Section 53(3)(a)(i) of the 1981 Act, namely, the diversion (as authorised by this Order) of a highway shown or required to be shown in the map and statement.

Welbury Parish Council have been consulted as required by Section 120(2) of the 1980 Act.

BY THIS ORDER:

1. The public rights of way over the land situated at Wray House, Welbury and shown by a bold continuous line on the map contained in this Order and described in Part 1 of the Schedule to this Order shall be stopped up on the date on which the Authority certifies, in accordance with Section 119(3)(b) of the 1980 Act, that work to the new sections of path, as described in Part 2 of the Schedule, has been completed to the reasonable satisfaction of the Authority. Under no circumstances shall such certification be given before the date of confirmation of this Order.
2. There shall from the date of the above mentioned certification be Public Footpaths over the land situated at Wray House, Welbury described in Part 2 of the Schedule to this Order and shown by a bold broken line on the map contained in this Order.
3. The following works shall be carried out by the applicant in relation to the highway described in Part 2 of the Schedule: Pedestrian gates to BS5709:2018 to be installed at Points E and F on the attached plan.
4. The rights conferred on the public under this Order shall be subject to the limitations and conditions set out in Part 3 of the Schedule.
5. The District of Hambleton (outside The North York Moors National Park) Definitive Statement shall be modified as described in Part 4 of the Schedule to this Order.

THE COMMON SEAL of THE NORTH
YORKSHIRE COUNCIL

was hereunto affixed this ^{4th} day
of MARCH 2025,
in the presence of:-

Catrina Cable



SCHEDULE

PART 1

DESCRIPTION OF SITE OF EXISTING PUBLIC FOOTPATHS

<u>Section of Public Footpath to be extinguished as shown on the attached map</u>	<u>Position</u>	<u>Width</u>
Public Footpath 10.164/1 as marked with a bold continuous line (A-B-C) on the attached plan.	From Grid Reference 43927 49965 (Point A) proceeds in a generally north east direction through the farmyard of Wray House for approximately 46 metres to Grid Reference 43931 49967 (Point B) and then proceeds in an east north east direction for approximately 84 metres to Grid Reference 43939 49969 (Point C).	Not Recorded
<u>Section of Public Footpath to be extinguished as shown on the attached map</u>	<u>Position</u>	<u>Width</u>
Public Footpath 10.164/2 as marked with a bold continuous line (B-D) on the attached plan	From Grid Reference 43931 49967 (Point B) proceeds in a north east direction for approximately 86 metres to Grid Reference 43937 49973 (Point D).	Not Recorded

PART 2

DESCRIPTION OF SITE OF NEW PUBLIC FOOTPATHS

<u>Section of Public Footpath to be created as shown on the attached map</u>	<u>Position</u>	<u>Width</u>
Public Footpath 10.164/1 as marked with a bold dashed line (A-E-F-C) on the attached map.	From Grid Reference 43927 49965 (Point A) proceeds in a generally south east direction for approximately 15 metres to a pedestrian gate at Grid Reference 43929 49964 (Point E) and then continues in a generally south east direction for approximately 26 metres to a pedestrian gate at Grid Reference 43931 49962 (Point F) and then proceeds in a north east direction for approximately 109 metres to Grid Reference 43939 49969 (Point C).	2 metres
<u>Section of Public Footpath to be created as shown on the attached map</u>	<u>Position</u>	<u>Width</u>
Public Footpath 10.164/2 as marked with a bold dashed line (C-D) on the attached map.	From Grid Reference 43939 49969 (Point C), proceeds in a north north west direction for approximately 47 metres to Grid Reference 43937 49973 (Point D).	2 metres

PART 3

LIMITATIONS AND CONDITIONS

<u>Position on Public Footpath 10.164/1 to which limitations and conditions apply</u>	<u>Limitations and Conditions</u>
Grid Reference 43929 49964 (Point E)	Pedestrian Gate to BS5709:2018
Grid Reference 43931 49962 (Point F)	Pedestrian Gate to BS5709:2018

PART 4

MODIFICATION OF DEFINITIVE STATEMENT
VARIATION OF PARTICULARS OF PATH OR WAY

Path No.	Grid Reference End Points	Description	Nature of Surface	Length (Km)	Width (m)	Lawful Obstructions and Conditions
Public Footpath 10.164/1	Not Recorded.	Not Recorded	Not Recorded	Not Recorded	Not Recorded	Not Recorded
		From Grid Reference 43927 49965 proceeds in a generally south east direction for approximately 15 metres to a pedestrian gate at Grid Reference 43929 49964 and then continues in a generally south east direction for approximately 26 metres to a pedestrian gate at Grid Reference 43931 49962 and then proceeds in a north east direction for approximately 109 metres to Grid Reference 43939 49969.	Grass	0.15	2 metres	Pedestrian Gate GR 43929 49964 Pedestrian Gate GR 43931 49962
		Not Recorded	Not Recorded	Total: Not Recorded	Not Recorded	Not Recorded
Public Footpath 10.164/2	Not Recorded.	Not Recorded.	Not Recorded	Not Recorded	Not Recorded	Not Recorded
		From Grid Reference 43939 49969, proceeds in a north north west direction for approximately 47 metres to Grid Reference 43937 49973.	Grass	0.047	2 metres	
		Not Recorded	Not Recorded	Total: Not Recorded	Not Recorded	Not Recorded

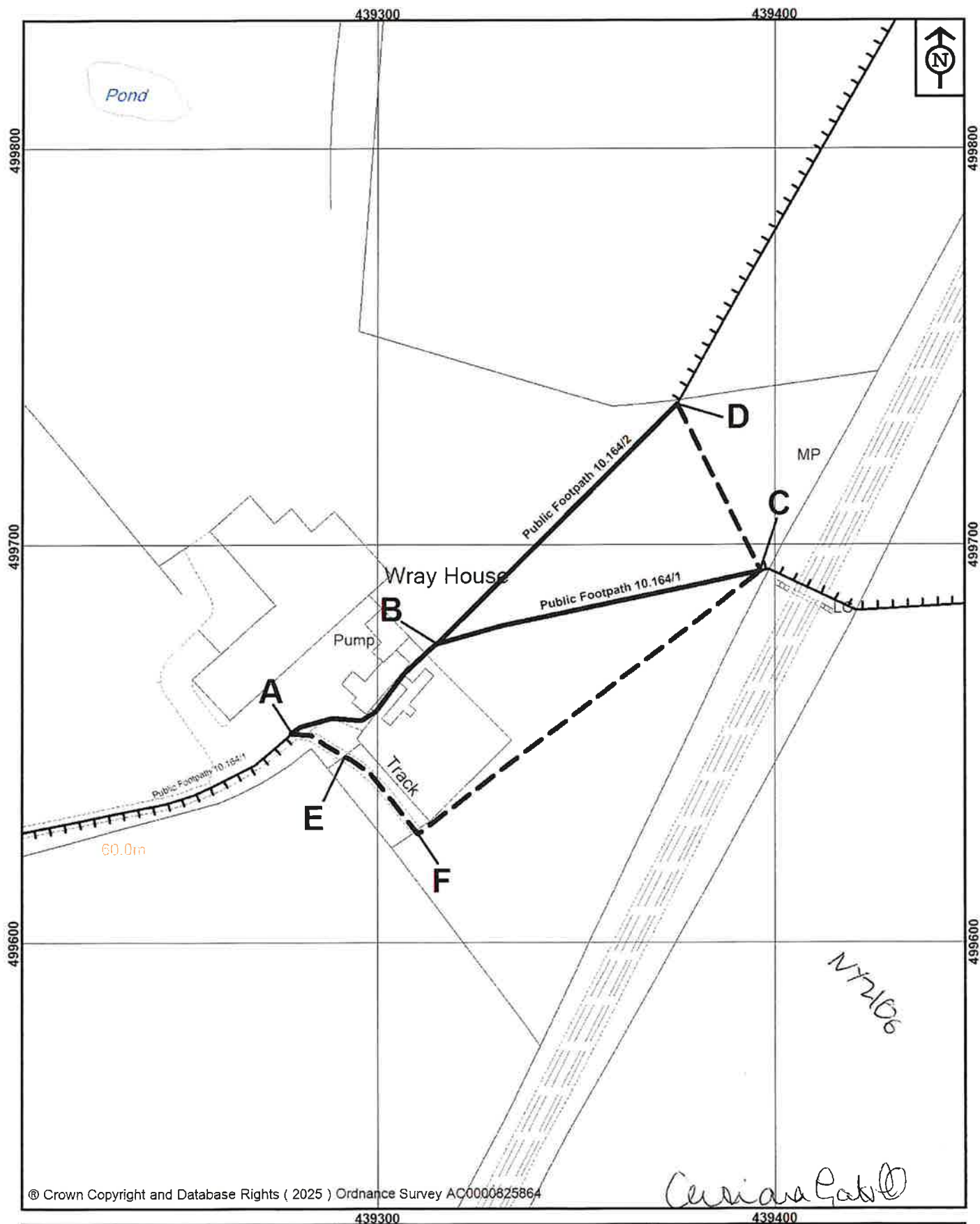

**NORTH
YORKSHIRE
COUNCIL**

Public Rights of Way
Countryside Access Service
County Hall
Northallerton
DL7 8AH

Key:

Footpath to be added

Footpath to be deleted

Other footpaths



Map drawn on 26 February 2025

Drawn by SCM

Scale 1:1250

The North Yorkshire Council

Highways Act 1980 Section 119

Wildlife & Countryside Act 1981

Public Footpaths Nos 10.164/1 &
10.164/2, Wray House, Welbury

Diversion Order 2025

File Ref No. HAM/2022/24/DO

**PUBLIC PATH DIVERSION AND
DEFINITIVE MAP AND STATEMENT MODIFICATION ORDER**

HIGHWAYS ACT 1980

WILDLIFE AND COUNTRYSIDE ACT 1981

THE NORTH YORKSHIRE COUNCIL

**PUBLIC FOOTPATHS NOS 10.164/1 & 10.164/2, WRAY HOUSE, WELBURY DIVERSION
ORDER 2025**

THE NORTH YORKSHIRE COUNCIL in exercise of the powers conferred upon it in that behalf hereby confirm the foregoing Order (without any modification) as an Unopposed Order.

IN WITNESS whereof
THE COMMON SEAL of THE NORTH
YORKSHIRE COUNCIL
was hereunto affixed this 15th day
of April
in the presence of:-



**AUTHORISED
SIGNATORY**



241259