



PART B APPLICATION FORM

Application for a permit

**Local Authority Pollution Prevention and Control
Pollution Prevention and Control Act 1999
Environmental Permitting (England and Wales) Regulations 2016 (as amended)**

Introduction

When to use this form

This environmental permitting regime is known as and referred to as Local Authority Pollution Prevention and Control ('LAPPC'). Installations permitted under this regime are known as Part 'B' installations. Use this form if you are sending an application for a 'Part B' permit to a Local Authority under the Environmental Permitting (England and Wales) Regulations 2016 ("the EP Regulations").

Before you start to fill in this form

You are strongly advised to read relevant parts of the Defra general guidance manual issued for LA-IPPC and LAPPC, republished in March 2010 and available at <http://www.defra.gov.uk/environment/quality/pollution/ppc/localauth/pubs/guidance/manuals.htm>. This contains a list of other documents you may need to refer to when you are preparing your application, and explains some of the technical terms used. You will also need to read the relevant Process Guidance note. The EP Regulations can be obtained from The Office of Public Sector Information, or viewed on their website at http://www.opsi.gov.uk/legislation/about_legislation.htm.

Which parts of the form to fill in

You should fill in as much of this form as possible. The appropriate fee must be enclosed with the application to enable it to be processed further. When complete return to:

North Yorkshire Council
Regulatory Services
County Hall
Racecourse Lane
Northallerton
North Yorkshire
DL7 8AD

Tel: 0300 131 2131

Email: scientific@northyorks.gov.uk

Other documents you may need to submit

There are number of other documents you will need to send us with your application. Each time a request for a document is made in the application form you will need to record a document reference number for the document or documents that you are submitting in the space provided

on the form for this purpose. Please also mark the document(s) clearly with this reference number and the application reference number, if you have been given one, which will be at the top of the form overleaf. If you do not have either of these, please use the name of the installation.

Using continuation sheets

In the case of the questions on the application form itself, please use a continuation sheet if you need extra space; but please indicate clearly on the form that you have done so by stating a document reference number for that continuation sheet. Please also mark the continuation sheet itself clearly with the information referred to above.

Copies - not relevant for e-applications

Please send the original and two copies of the form and all other supporting material, to assist the Authority in conducting any necessary consultation process.

If you need help and advice

We have made the application form as straightforward as possible, but please get in touch with us at the local authority address given above if you need any advice on how to set out the information we need.

Corporate Fair Processing- Data Protection

Any information you give to us will be held securely and in accordance with the rules on data protection. We will treat personal details as private and confidential and safeguard them. We will not disclose them to anyone unconnected with the Council unless you have consented to their release, or in certain circumstances where:
we are legally obliged to do so;

- disclosure is necessary for the proper discharge of our statutory functions;
- disclosure is necessary to enable us to provide you with a requested service or deal with your enquiry;
- we are under a duty to protect public funds. We may use the information you have provided for the prevention and detection of fraud. We may also share this information with other bodies responsible for public funds or for auditing them for these purposes

For further information on how we collect, use, share, secure and retain your personal information, and your legal rights, please see our Privacy Notice at <https://northyorks.gov.uk/your-council/transparency-freedom-information-and-data-protection/privacy-notices/nyc-environmental-health-privacy-notice> or by contacting our Data Protection Officer on infoqov@northyorks.gov.uk

LAPPC application form: to be completed by the operator		
For Local Authority use		
Application reference	Officer reference	Date received

A1 Applicant details

A1.1 Name of the installation

Duckett Hill Quarry

A1.2 Please give the address of the site of the installation

Duckett Hill Quarry, Kneeton Lane, Middleton Tyas, Richmond, DL10 6NN

Postcode DL10 6NN

Telephone

The Ordnance Survey national grid reference 8 characters, for example, SJ 123 456 (can be obtained from typing postcode into one of the on-line mapping sites).

N	Z	2	1	5	0	7	2
---	---	---	---	---	---	---	---

A1.3 Existing permits

Please give details of any existing LAPPC or LA-IPPC authorisation for the installation, or any waste management licences or water discharge consents, including reference number(s) and type(s):

We do not have copies of the permit(s) issued to previous operators of the quarry site. For information, however, please find attached Part B Permits issued by Durham County Council for three of the mobile crushing and screening plant now transferred to Duckett Hill Quarry. See Doc 1.0 and Docs 2.1, 2.2 and 2.3

Please provide the information requested below about the "Operator", which means the person who it is proposed will have control over the installation in accordance with the permit (if granted)

A2.1 The Operator – Please provide the full name of company, partnership or corporate body

Duckett Hill Quarry Limited

Trading/business name (if different)

Registered Office address

Stotforth Hill House, Windlestone Park, Ferryhill, Co Durham

Postcode: DL17 0NF

Principal Office address (if different)

Postcode:

Company registration number

14379139

A2.2 Holding Companies

Is the operator a subsidiary of a holding company within the meaning of section 1159 of the Companies Act 2006?

No ☐

Yes ☒ *name of ultimate holding company*

Windlestone Minerals Ltd

Registered office address

Stotforth Hill House, Windlestone Park, Ferryhill, Co Durham

Postcode DL17 0NF

Principal Office address (if different)

Postcode

Company registration number: 13650031

A3.1 Who can we contact about your application?

It will help to have someone who we can contact directly with any questions about your application. The person you name should have the authority to act on behalf of the operator - This can be an agent or consultant.

Name [redacted]

Position Director

Address Stotforth Hill House, Windlestone Park, Ferryhill, Co Durham

Postcode DL17 0NF

Telephone number [redacted]

Fax number

email address [redacted]

B1 About the installation

Please fill in the table below with details of all the current activities in operation at the whole installation.

In Column 1, Box A, please identify all activities listed in Schedule 1 to the EP Regulations that are, or are proposed, to be carried out in the stationary technical unit of the installation.

In Column 1, Box B please identify any directly associated activities that are, or are proposed, to be carried out on the same site which:

- * have a technical connection with the activities in the stationary technical unit
- * could have an effect on pollution

In Column 2, for Boxes A and B please quote the Chapter number, Section number, then paragraph and sub-paragraph number as shown in Part 2 of Schedule 1 to the EP Regulations [For example, *Manufacturing glass and glass fibre where the use of lead or any lead compound is involved*, would be listed as Chapter 3, Section 3.3, Part B(b)].

B1.1 Installation table for new permit application

COLUMN 1	COLUMN 2
Box A Activities in the stationary technical unit	Section in Schedule 1 to the EP Regulations
(a)Unless falling within Part A(1) or Part A(2) of any Section, the crushing, grinding or other size reduction, other than the cutting of stone, or the grading, screening or heating of any designated mineral or mineral product except where the operation of the activity is unlikely to result in the release into the air of particulate matter. (c)The crushing, grinding or other size reduction, with machinery designed for that purpose, of bricks, tiles or concrete. (d)Screening the product of any activity described in paragraph (c).	Part 2, Chapter 3, Section 3 Part B
Box B Directly-associated activities	Schedule 1 references (if any)

Operation of Part B process as above via mobile plant.	As above

B1.2 Why is the application being made?

- ☒ The installation is new
- ☐ The installation is existing, but changes to the installation or to the EP Regulations means that an LAPPC Part B permit is now required.

B.1.3 Site Maps

Please provide:-

* A suitable map showing the location of the installation clearly defining extent of the installations in red

Doc Reference Doc 3.0 Location Plan

* A suitable plan showing the layout of activities on the site, including bulk storage of materials, waste storage areas and any external emission points to atmosphere

Doc Reference Docs 4.1 – 4.13

B2 The Installation

Please provide written information about the aspects of your installation listed below. We need this information to determine whether you will operate the installation in a way in which all the environmental requirements of the EP Regulations are met.

B2.1 Describe the proposed installation and activities and identify the foreseeable emissions to air from each stage of the process (this will include any foreseeable emissions during start up, shut down and any breakdown/abnormal operation)

The use of process flow diagrams may aid to simplify the operations

Doc Reference: Doc 1.0, 5.0 & 6.0.

The mobile plant will be inspected in accordance with the requirements of the Part B Permit when issued.

B2.2 Once all foreseeable emissions have been identified in the proposed installation activities, each emission should be characterised (including odour) and quantified.

Atmospheric emissions should be categorised under the following

- i. point source, (e.g. chimney / vent, identified by a number and detailed on a plan)
- ii. fugitive source (e.g. from stockpiles / storage areas).

If any monitoring has been undertaken please provide the details of emission concentrations and quantify in terms of mass emissions. If no monitoring has been undertaken please state this.

(Emission concentration = e.g. milligrams per cubic metre of air; mass emission = e.g. grams per hour, tonnes per year)

B2.3 For each emission identified from the installations' activities describe the current and proposed technology and other techniques for preventing or, where that is not practicable, reducing the emissions into the air. If no techniques are currently used and the emission goes directly to the environment, without abatement or treatment then this should be stated

Doc Reference: Doc 7.0 Dust Emission Management Plan

B2.4 Describe the proposed systems to be used in the event of unintentional releases and their consequences. This must identify, assess and minimise the environmental risks and hazards, provide a risk based assessment of any likely unintentional releases, including the use of historical evidence. If no assessments have been carried out please state.

Doc Reference: Doc 7.0 Dust Emission Management Plan

B2.5 Describe the proposed measures for monitoring all identified emissions including any environmental monitoring, and the frequency, measurement methodology and evaluation procedure proposed (e.g. particulate matter emissions, odour etc). Include the details of any monitoring which has been carried out which has not been requested in any other part of this application. If no monitoring is proposed for an emission please state the reason.

Doc Reference: Doc 7.0 Dust Emission Management Plan

B2.6 Provide detailed procedures and policies of your proposed environmental management techniques, in relation to the installation activities described.

Doc Reference: Doc 7.0 Dust Emission Management Plan

B3 Impact on the Environment

B3.1 Provide an assessment of the potential significant local environmental effects of the foreseeable emissions (e.g. is there a history of complaints and/or is the installation in an air quality management area ?)

Doc Reference: Doc 7.0 Dust Emission Management Plan

B3.2 Are there any sites of special scientific interest (SSSIs) or European protected sites which are within either

- 2 kilometres for an installation which includes Part B combustion, incineration (but not crematoria), iron and steel, and non-ferrous metal activities, or
- 1 kilometre for Part B mineral activities and cement and lime activities, or
- ½ a kilometre for all other Part B activities 2 kilometres of the installation?

No ☒

Yes ☐ *please give names of the sites*

B3.3 Provide an assessment of whether the installation is likely to have a significant effect on such sites and, if it is, provide an assessment of the implications of the installation for that site, for the purposes of the Conservation (Natural Habitats etc) Regulations 1994 (see appendix 2 of Annex XVIII of the General Guidance Manual).

Doc Reference: N/A

B4 Environmental Statements

B4.1 Has an environmental impact assessment been carried out under The Town and Country Planning (Environmental Impact Assessment)(England & Wales) Regulations 1999/293, or for any other reason with respect to the installation?

No ☒

Yes ☐ *Please supply a copy of the environmental impact assessment and details of any decision made*

Doc Reference: Doc 8.0

B5 Additional information

Please supply any additional information which you would like us to take account of in considering this application.

Doc Reference N/A

C1 Fees and Charges

The enclosed charging scheme leaflet gives details of how to calculate the application fee. Your application cannot be processed unless the application fee is correct and enclosed.

C1.1 Please state the amount enclosed as an application fee for this installation.

£362.00 (cheques should be made payable to North Yorkshire Council)

We will confirm receipt of this fee when we write to you acknowledging your application.

C1.2 Please give any company purchase order number or other reference you wish to be used in relation to this fee.

C2 Annual subsistence charges

If we grant you a permit, you will be required to pay an annual subsistence charge, failure to do so will result in revocation of your permit and you will not be able to operate your installation.

C2.1 Please provide details of the address you wish invoices to be sent to and details of someone we may contact about fees and charges within your finance section.

Stotforth Hill House, Windlestone Park, Ferryhill, Co Durham

Contact –

Postcode: DL10 6NN

Telephone:

C3 Commercial confidentiality

C3.1 Is there any information in the application that you wish to justify being kept from the public register on the grounds of commercial or industrial confidentiality?

No

[GH1]

Please provide full justification, considering the definition of commercial confidentiality within the EP regulations.

Doc Reference _____

C3.2 Is there any information in the application that you believe should be kept from the public register on the grounds of national security?

No

Do not write anything about this information on the form. Please provide full details on separate sheets, plus provide a copy of the application form to the Secretary of State/Welsh Ministers for a Direction on the issue of National Security.

C4 Data Protection

The information you give will be used by the Local Authority to process your application. It will be placed on the relevant public register and used to monitor compliance with the permit conditions. We may also use and or disclose any of the information you give us in order to:

- consult with the public, public bodies and other organisations,
- carry out statistical analysis, research and development on environmental issues,
- provide public register information to enquirers,
- make sure you keep to the conditions of your permit and deal with any matters relating to your permit
- investigate possible breaches of environmental law and take any resulting action,
- prevent breaches of environmental law,
- offer you documents or services relating to environmental matters,
- respond to requests for information under the Freedom of Information Act 2000 and the Environmental Information Regulations 2004 (if the Data Protection Act allows)
- assess customer service satisfaction and improve our service.

We may pass on the information to agents/ representatives who we ask to do any of these things on our behalf.

It is an offence under Regulation 38 of the EP Regulations, for the purpose of obtaining a permit (for yourself or anyone else) to:

- make a false statement which you know to be false or misleading in a material particular,
- recklessly make a statement which is false or misleading in a material particular.

If you make a false statement

- we may prosecute you, and
- if you are convicted, you are liable to a fine or imprisonment (or both).

C5 Declaration: previous offences (delete whichever is inapplicable)

I/We certify

EITHER

No offences have been committed in the previous five years which are relevant to my/our competence to operate this installation in accordance with the EP Regulations.

OR

The following offences have been committed in the previous five years which may be relevant to my/our competence to operating this installation in accordance with the Regulations:

Signature _____

Name _____

Position _____ Director _____

Date _____

7th July 2025.

C6 Declaration

C6.1 Signature of current operator(s)*

I/We certify that the information in this application is correct. I/We apply for a permit in respect of the particulars described in this application (including supporting documentation) I/We have supplied.

Please note that each individual operator must sign the declaration themselves, even if an agent is acting on their behalf.

For the application from:

Installation name: Duckett Hill Quarry

Signature _____

Name _____

Position Director

Date _____

Signature _____

Name _____

Position _____

Date _____

** Where more than one person is defined as the operator, all should sign. Where a company or other body corporate – an authorised person should sign and provide evidence of authority from the board of the company or body corporate.*



PART B APPLICATION FORM

Application for a permit

**Local Authority Pollution Prevention and Control
Pollution Prevention and Control Act 1999
Environmental Permitting (England and Wales) Regulations 2016 (as amended)**

Introduction

When to use this form

This environmental permitting regime is known as and referred to as Local Authority Pollution Prevention and Control ('LAPPC'). Installations permitted under this regime are known as Part 'B' installations. Use this form if you are sending an application for a 'Part B' permit to a Local Authority under the Environmental Permitting (England and Wales) Regulations 2016 ("the EP Regulations").

Before you start to fill in this form

You are strongly advised to read relevant parts of the Defra general guidance manual issued for LA-IPPC and LAPPC, republished in March 2010 and available at <http://www.defra.gov.uk/environment/quality/pollution/ppc/localauth/pubs/guidance/manuals.htm>. This contains a list of other documents you may need to refer to when you are preparing your application, and explains some of the technical terms used. You will also need to read the relevant Process Guidance note. The EP Regulations can be obtained from The Office of Public Sector Information, or viewed on their website at http://www.opsi.gov.uk/legislation/about_legislation.htm.

Which parts of the form to fill in

You should fill in as much of this form as possible. The appropriate fee must be enclosed with the application to enable it to be processed further. When complete return to:

North Yorkshire Council
Regulatory Services
County Hall
Racecourse Lane
Northallerton
North Yorkshire
DL7 8AD

Tel: 0300 131 2131

Email: scientific@northyorks.gov.uk

Other documents you may need to submit

There are number of other documents you will need to send us with your application. Each time a request for a document is made in the application form you will need to record a document reference number for the document or documents that you are submitting in the space provided

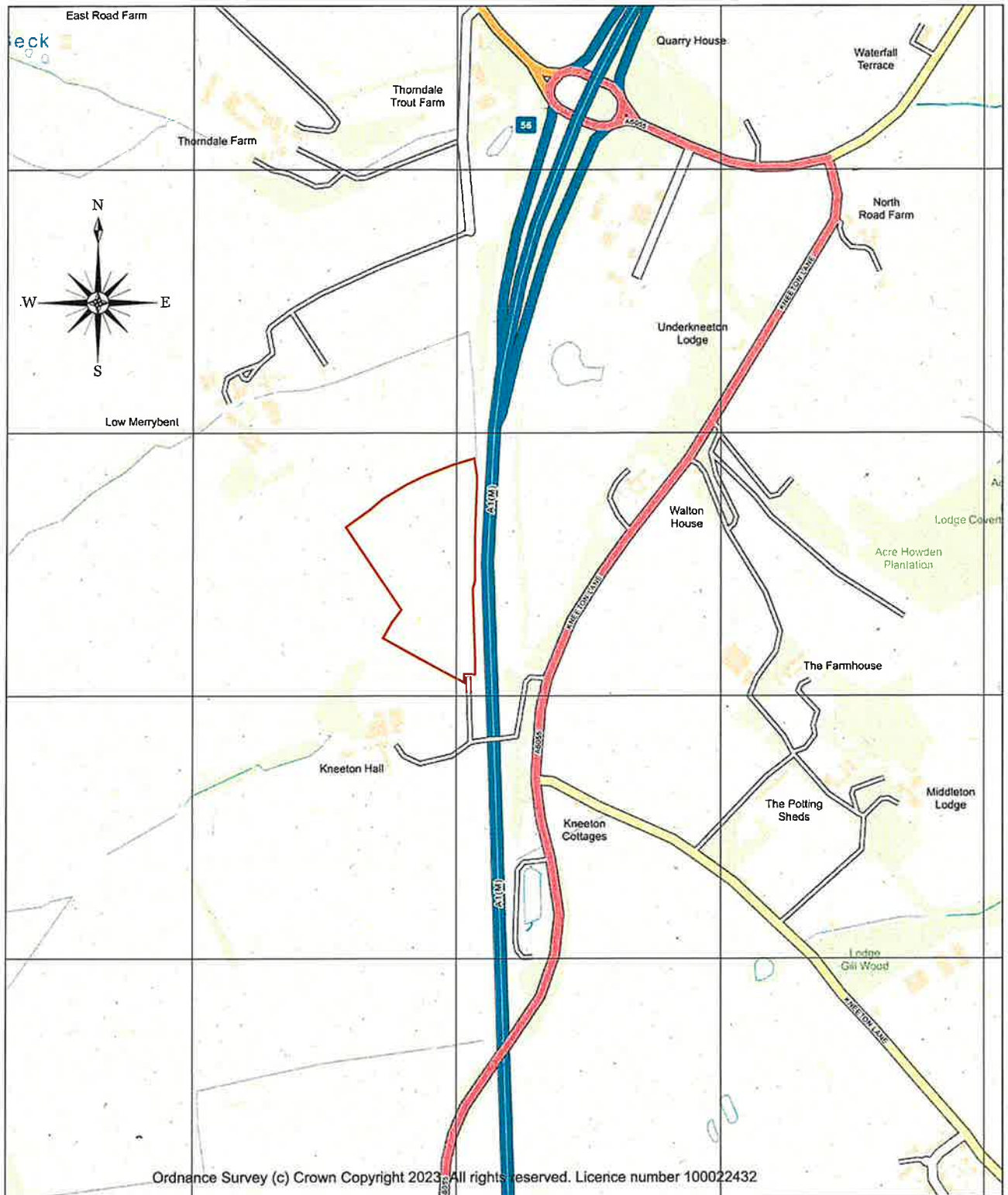

Date: 21st June 2024

Drawing No. 1

Site Ref. 2458

File No. FL/PA/SSV/1

Drawn by: MHO

Approved By: AED/KW

Duckett Hill

Location Plan



Site Boundary: —

Scale: 1:10,000

