

NORTH YORKSHIRE COUNCIL
(TEMPORARY PROHIBITION OF PEDESTRIANS)
PUBLIC FOOTPATH 15.76/1/1, LEATHLEY
ORDER 2025 NO 509

Road Traffic Regulation Act 1984 – Section 14(1)
(as amended)

North Yorkshire Council has made this Order to prohibit any pedestrian from using Public Footpath, 15.76/1/1 in the Parish of Leathley, between grid reference SE22064733 and SE23164730 for a temporary period of up to six months (subject to access to premises) between 29th December 2025 and 7th June 2026 due to an unsafe bridge.

This Order follows Emergency Notice No 230.

The closure period will be indicated by the placing of traffic signs

All enquiries to: Customer Services @ 0300 131 2 131

Further details can be viewed at:
<https://www.northyorks.gov.uk/rights-way-public-notices>.

Dated: 25th December 2025

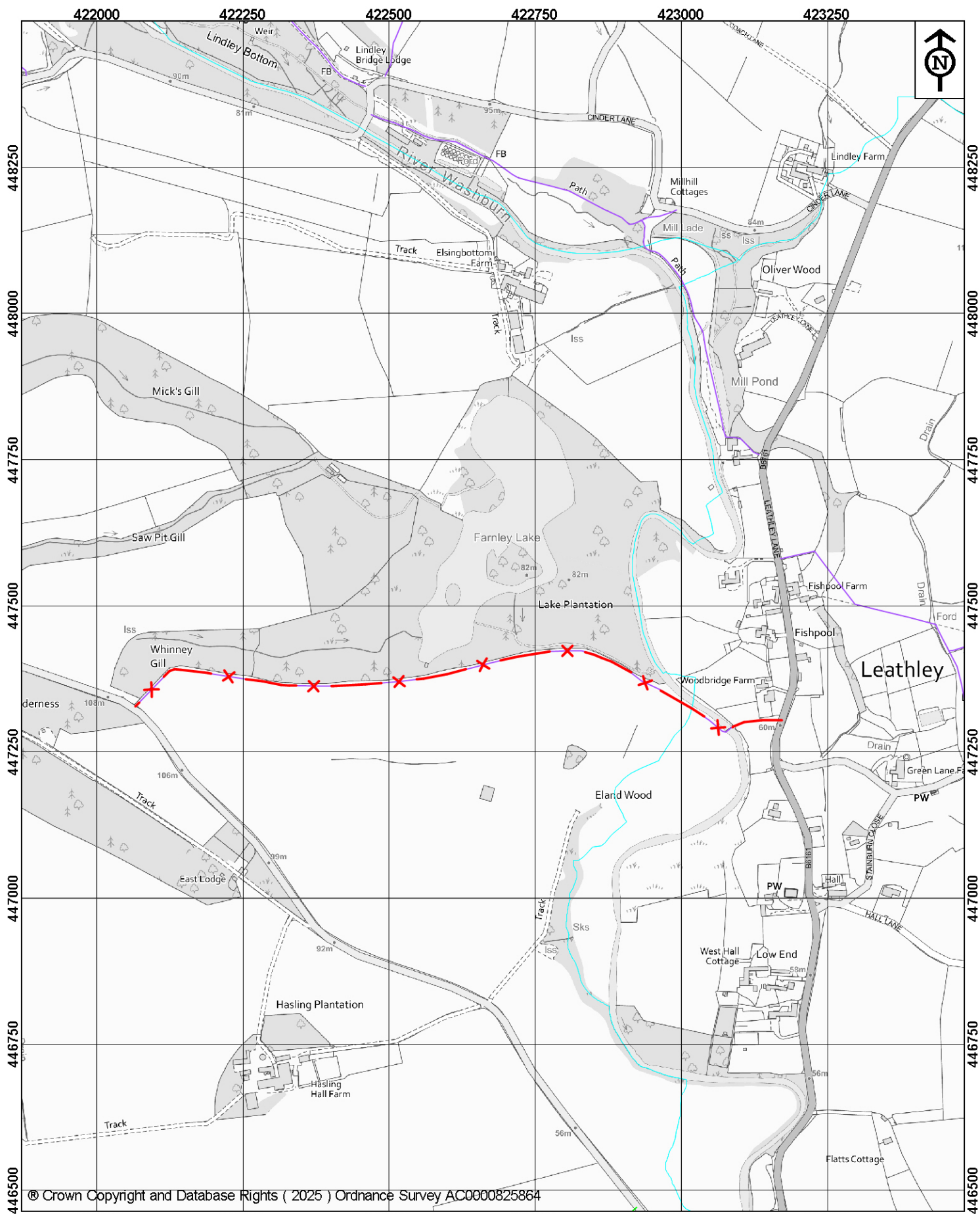

© Crown Copyright and Database Rights (2025) Ordnance Survey AC0000825864



**NORTH
YORKSHIRE
COUNCIL**

Public Rights of Way
Countryside Access Service
County Hall
Northallerton
DL7 8AH

Key:

Closed route



Public Footpath



Map drawn on 8 December 2025

Drawn by DS

Scale 1:8500

The North Yorkshire Council

Temporary closure of
Public Footpath 15.76/1/1 in
Leathley

File Ref No. 72/15/76/1/1/08/12/25