

THE NORTH YORKSHIRE COUNCIL
TEMPORARY CLOSURE OF PUBLIC FOOTPATH
15.76/1/1 LEATHLEY
EMERGENCY NOTICE NO 230

ROAD TRAFFIC REGULATION ACT
1984 - SECTION 14(2b) (AS AMENDED)

North Yorkshire Council hereby gives notice that from 8th December 2025 until 28th December 2025 inclusive, no pedestrian shall proceed along Public Footpath 15.76/1/1 in the Parish of Leathley between grid references SE22064733 and SE23164730, due to an unsafe bridge.

This Emergency closure will be followed by a six month closure until 7th June 2026.

The closure will be put into effect when necessary by means of the erection of notices and signs.

All enquiries to: Customer Services @ 0300 131 2 131

Dated 8th December 2025

BARRY KHAN
Assistant Chief Executive (Legal and Democratic Services)

OFFICIAL

OFFICIAL

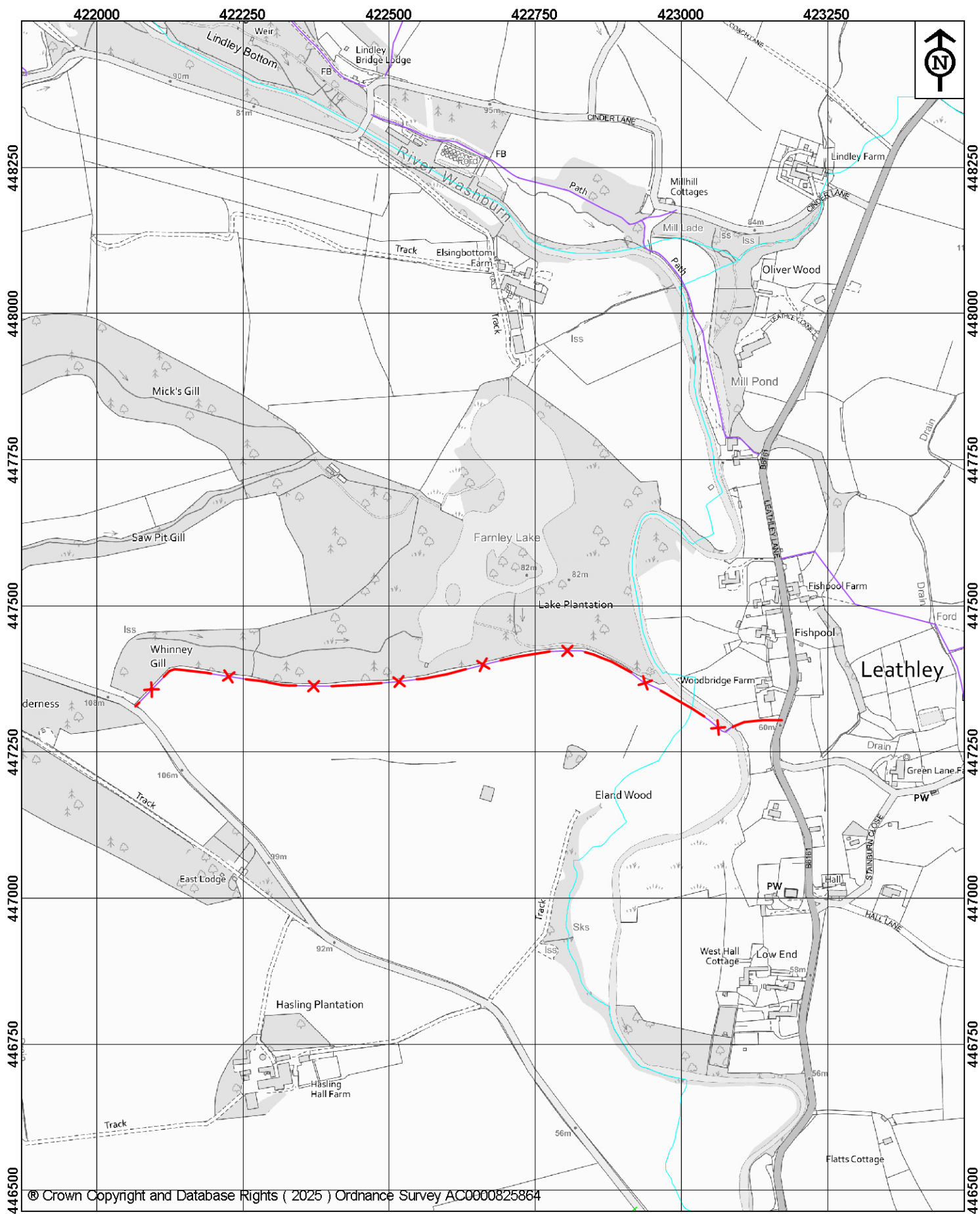

**NORTH
YORKSHIRE
COUNCIL**

Public Rights of Way
Countryside Access Service
County Hall
Northallerton
DL7 8AH

Key:

Closed route



Public Footpath



Map drawn on 8 December 2025

Drawn by DS

Scale 1:8500

The North Yorkshire Council

Temporary closure of
Public Footpath 15.76/1/1 in
Leathley

File Ref No. 72/15/76/1/1/08/12/25