

SITE NOTICE

**NOTICE OF CONFIRMATION OF A PUBLIC PATH DIVERSION AND
DEFINITIVE MAP AND STATEMENT MODIFICATION ORDER**

HIGHWAYS ACT 1980 WILDLIFE AND COUNTRYSIDE ACT 1981

THE NORTH YORKSHIRE COUNCIL

**PUBLIC FOOTPATH NOS. 20.26/1 & 20.8/3 & 20.8/4, ELLERTON ON SWALE & BOLTON ON
SWALE DIVERSION ORDER 2025.**

On 12.12.25, North Yorkshire Council confirmed the above Order made under Section 119 of the Highways Act 1980 and Section 53A(2) of the Wildlife and Countryside Act 1981.

The effect of the Order as confirmed is to divert the Public Footpaths described below and modify The District of Richmondshire (outside The Yorkshire Dales National Park) Definitive Map and Statement accordingly.

Public Footpath No. 20.26/1 between SE 2590 9864 and SE 2616 9823 will be diverted onto a new route between SE 2590 9858 and SE 2614 9822. Public Footpath No. 20.8/3 between SE 2580 9870 and SE 2590 9864 will be diverted onto a new route between SE 2580 9870 and SE 2590 9858. Public Footpath No. 20.8/4 between SE 2580 9870 and SE 2546 9846 will be diverted onto a new route between SE 2590 9858 and SE 2569 9839.

A copy of the Order as confirmed and the Order Map have been placed and may be seen free of charge during normal office hours at Colburn Community Library, North Yorkshire until 20.02.26. Copies of the Order and Map may be purchased from Countryside Access Service, North Yorkshire Council, County Hall, Northallerton, North Yorkshire, DL7 8AD (tel: 01609 532512) at a cost of £2.00, or can be downloaded free from our website www.northyorks.gov.uk/pathnotices.

The Order comes into force on the date on which the Authority certifies, in accordance with Section 119(3)(b) of the 1980 Act, that work to the new section of path, described in part 2 of the Schedule, has been completed, but if a person aggrieved by the Order wants to question its validity, or that of any provision contained in it, on the ground that it is not within the powers of the Highways Act 1980 as amended, or on the ground that any requirement of the Act, as amended, or of any regulation made under the Act has not been complied with in relation to the Order, he or she may, under Paragraph 2 of Schedule 2 to the Act as applied by Paragraph 5 of Schedule 6 to the Act, within six weeks from 09.01.26 make an application to the High Court.

Dated: 09.01.26

Barry Khan
Assistant Chief Executive
(Legal and Democratic Services)
County Hall
Northallerton
North Yorkshire
DL7 8AH



**PUBLIC PATH DIVERSION AND
DEFINITIVE MAP AND STATEMENT MODIFICATION ORDER**

**HIGHWAYS ACT 1980
WILDLIFE AND COUNTRYSIDE ACT 1981**

THE NORTH YORKSHIRE COUNCIL

**PUBLIC FOOTPATH NOS. 20.26/1 & 20.8/3 & 20.8/4, ELLERTON ON
SWALE & BOLTON ON SWALE DIVERSION ORDER 2025**

Barry Khan
Assistant Chief Executive
(Legal and Democratic Services)
County Hall
Northallerton
DL7 8AH

**PUBLIC PATH DIVERSION AND
DEFINITIVE MAP AND STATEMENT MODIFICATION ORDER**

**HIGHWAYS ACT 1980
WILDLIFE AND COUNTRYSIDE ACT 1981**

THE NORTH YORKSHIRE COUNCIL

**PUBLIC FOOTPATH NOS. 20.26/1 & 20.8/3 & 20.8/4, ELLERTON ON SWALE & BOLTON
ON SWALE DIVERSION ORDER 2025**

This Order is made by The North Yorkshire Council ("the Authority") under Section 119 of the Highways Act 1980 ("the 1980 Act") because it appears to the Authority that in the interests of the owners of the land crossed by the Public Footpaths described in Paragraph 1 of this Order it is expedient that the line of the Public Footpaths should be diverted.

This Order is also made under Section 53A(2) of the Wildlife and Countryside Act 1981 ("the 1981 Act") because it appears to the Authority that The District of Richmondshire (outside The Yorkshire Dales National Park) Definitive Map and Statement require modification in consequence of the occurrence of an event specified in Section 53(3)(a)(i) of the 1981 Act, namely, the diversion (as authorised by this Order) of a highway shown or required to be shown in the Map and Statement.

Mr and Mrs Thompson of Laylands Farm, Ellerton on Swale, have agreed to defray any compensation which becomes payable in consequence of the coming into force of this Order.

Ellerton on Swale Parish Meeting has been consulted as required by Section 120(2) of the 1980 Act.

BY THIS ORDER:

1. The public rights of way over the land situated at Laylands Farm, Ellerton on Swale & Bolton on Swale and shown by a bold continuous line on the map contained in this Order and described in Part 1 of the Schedule to this Order shall be stopped up on the date on which the Authority certifies, in accordance with Section 119(3)(b) of the 1980 Act, that work to the new section of paths, as described in Part 2 of the Schedule, has been completed to the reasonable satisfaction of the Authority, and thereupon The District of Richmondshire (outside the Yorkshire Dales National Park) Definitive Map shall be modified by deleting from it these public rights of way. Under no circumstances shall such certification be given before the date of confirmation of this Order.
2. There shall from the date of the above-mentioned certification be Public Footpaths over the land situated at Laylands Farm, Ellerton on Swale & Bolton on Swale described in Part 2 of the Schedule to this Order and shown by a bold broken line on the map contained in this Order, and thereupon The District of Richmondshire (outside the Yorkshire Dales National Park) Definitive Map shall be modified by adding these paths to it.
3. The District of Richmondshire (outside The Yorkshire Dales National Park) Definitive Statement shall be modified as described in Part 4 of the Schedule to this Order.
4. The following works shall be carried out by the applicant in relation to the highway described in Part 2 of the Schedule: install pedestrian gates at Point C, F, G and I, install a field gate at Point H and undertake vegetation clearance between Point E and Point F.
5. The rights conferred on the public under this Order shall be subject to the limitations and conditions set out in Part 3 of the Schedule.

THE COMMON SEAL of THE NORTH
YORKSHIRE COUNCIL

was hereunto affixed this
of 17th October 2025
in the presence of:-

day

Ph...



**AUTHORISED
SIGNATORY**

SCHEDULE

PART 1

DESCRIPTION OF SITE OF EXISTING PUBLIC FOOTPATHS

<u>Section of Footpath to be extinguished as shown on the attached map</u>	<u>Position</u>	<u>Width</u>
Public Footpath No. 20.26/1 as marked with a bold continuous line (K-A) on the attached plan.	Starts at the Parish Boundary at Grid Reference 42590 49864 (Point K) and proceeds in a generally south south east direction for approximately 531 metres to its junction with the public highway at Grid Reference 42616 49823 (Point A).	Not Recorded/1.5 metres
Public Footpath No. 20.8/3 as marked with a bold continuous line (B-K) on the attached plan.	Starts at the stone bridge at Grid Reference 42580 49870 (Point B) and proceeds in a generally south south easterly direction for approximately 127 metres to the Parish Boundary at Grid Reference 42590 49864 (Point K).	1.5 metres/Not Recorded
Public Footpath No. 20.8/4 as marked with a bold continuous line (B-J) on the attached plan.	Starts at the stone bridge Grid Reference 42580 49870 (Point B) and proceeds in a generally west south westerly direction for approximately 416 metres to the public highway B6271 at Grid Reference 42546 49846 (Point J).	Not Recorded

PART 2

DESCRIPTION OF SITE OF NEW PUBLIC FOOTPATHS

<u>Section of Footpath to be created as shown on the attached map</u>	<u>Position</u>	<u>Width</u>
Public Footpath No. 20.26/1 as marked with a bold dashed line (H-G-F-E-D-C) on the attached plan.	Starts at the Parish Boundary at a field gate at Grid Reference 42590 49858 (Point H) and following the bank of Bolton Beck, proceeds in a generally south south easterly direction on grass for approximately 190 metres to a pedestrian gate at Grid Reference 42602 49843 (Point G), then in a generally south south easterly direction on grass and compacted crushed stone for approximately 17 metres to a pedestrian gate at Grid Reference 42603 49842 (Point F), then in a generally south south easterly direction on grass for approximately 25 metres to Grid Reference 42604 49840 (Point E), then in a generally south south easterly direction on grass for approximately 98 metres to Grid Reference 42604 49832 (Point D), then proceeds in a generally south south easterly direction on grass for approximately 161 metres to a pedestrian gate at Grid Reference 42614 49822 (Point C) at the junction with the public highway.	2 metres
Public Footpath No. 20.8/3 as marked with a bold dashed line (B-H) on the attached plan.	Starts at the stone bridge at Grid Reference 42580 49870 (Point B) and proceeds in a generally south south easterly direction on grass for approximately 176 metres following the bank of Bolton Beck to a field gate at Grid Reference 42590 49858 (Point H).	2 metres
Public Footpath No. 20.8/4 as marked with a bold dashed line (H-I) on the attached plan.	Starts at the Parish Boundary at a field gate at Grid Reference 42590 49858 (Point H) and proceeds in a generally west south westerly direction on grass for approximately 287 metres to a pedestrian gate at Grid Reference 42569 49839 (Point I) at the junction with the public highway B6271.	2 metres

PART 3

LIMITATIONS AND CONDITIONS

<u>Position on 20.26/1 & 20.8/4 to which limitations and conditions apply</u>	<u>Limitations and Conditions</u>
Grid Reference 42614 49822 (Point C)	Pedestrian Gate to BS5709:2018
Grid Reference 42603 49842 (Point F)	Pedestrian Gate to BS5709:2018
Grid Reference 42602 49843 (Point G)	Pedestrian Gate to BS5709:2018
Grid Reference 42590 49858 (Point H)	Field Gate to BS5709:2018
Grid Reference 42569 49839 (Point I)	Pedestrian Gate to BS5709:2018

PART 4

MODIFICATION OF DEFINITIVE STATEMENT

VARIATION OF PARTICULARS OF PATHS

[illegible]

		42602 49843, then in a generally south south easterly direction for approximately 17 metres to a pedestrian gate at Grid Reference 42603 49842, then in a generally south south easterly direction for approximately 25 metres to Grid Reference 42604 49840, then in a generally south south easterly direction for approximately 98 metres to Grid Reference 42604 49832, then proceeds in a generally south south easterly direction on grass for approximately 161 metres to a pedestrian gate at Grid Reference 42614 49822 and the junction with the public highway.	Compacted Crushed Stone	0.017		GR 42602 49843
			Grass	0.284		Pedestrian Gate to BS5709:2018 GR 42603 49842
	SE2616 9822 42614 49822 (Finish)			Total Length: 0.491		Pedestrian Gate to BS5709:2018 GR 42614 49822
Public Footpath No. 20.8/3	42534 49916 42580 49870 (Start) To	The footpath leaves the County Road at Grid Reference 42534 49916 and proceeds in a generally east to east south easterly direction, following the southern bank of Bolton Beck for approximately 400 metres to Grid Reference 42572 49912. The path then turns to a south to	Not Recorded	0.85	1.5	

		<p>south south easterly direction following the western bank of Bolton Beck for approximately 450 metres to the stone bridge at Grid Reference 42580 49870 and proceeds in a generally south south easterly direction for approximately 176 metres, following the bank of Bolton Beck to a field gate at Grid Reference 42590 49858. The footpath then continues for approximately 117 metres in a south easterly direction to end at the Parish Boundary at Grid Reference 42590 49863</p>	<p>Grass</p> <p>Not Recorded</p>	<p>0.176</p> <p>0.117</p> <p>Total Length:1.026</p>	<p>2</p> <p>Not Recorded</p>	
Public Footpath No. 20.8/4	<p>42590 49863 42590 49858 (Finish)</p> <p>42590 49858 (Start)</p> <p>To</p> <p>42569 49839 (Finish)</p>	<p>Not Recorded</p> <p>Starts at the Parish Boundary at Grid Reference 42590 49858 and proceeds in a generally south westerly direction for approximately 287 metres to a pedestrian gate at Grid Reference 42569 49839 at the junction with the public highway B6271.</p>	<p>Not Recorded</p> <p>Grass</p>	<p>Not Recorded</p> <p>0.287</p> <p>Total Length: Not Recorded</p>	<p>Not Recorded</p> <p>2</p>	<p>Pedestrian Gate to BS5709:2018 GR 42569 49839</p>

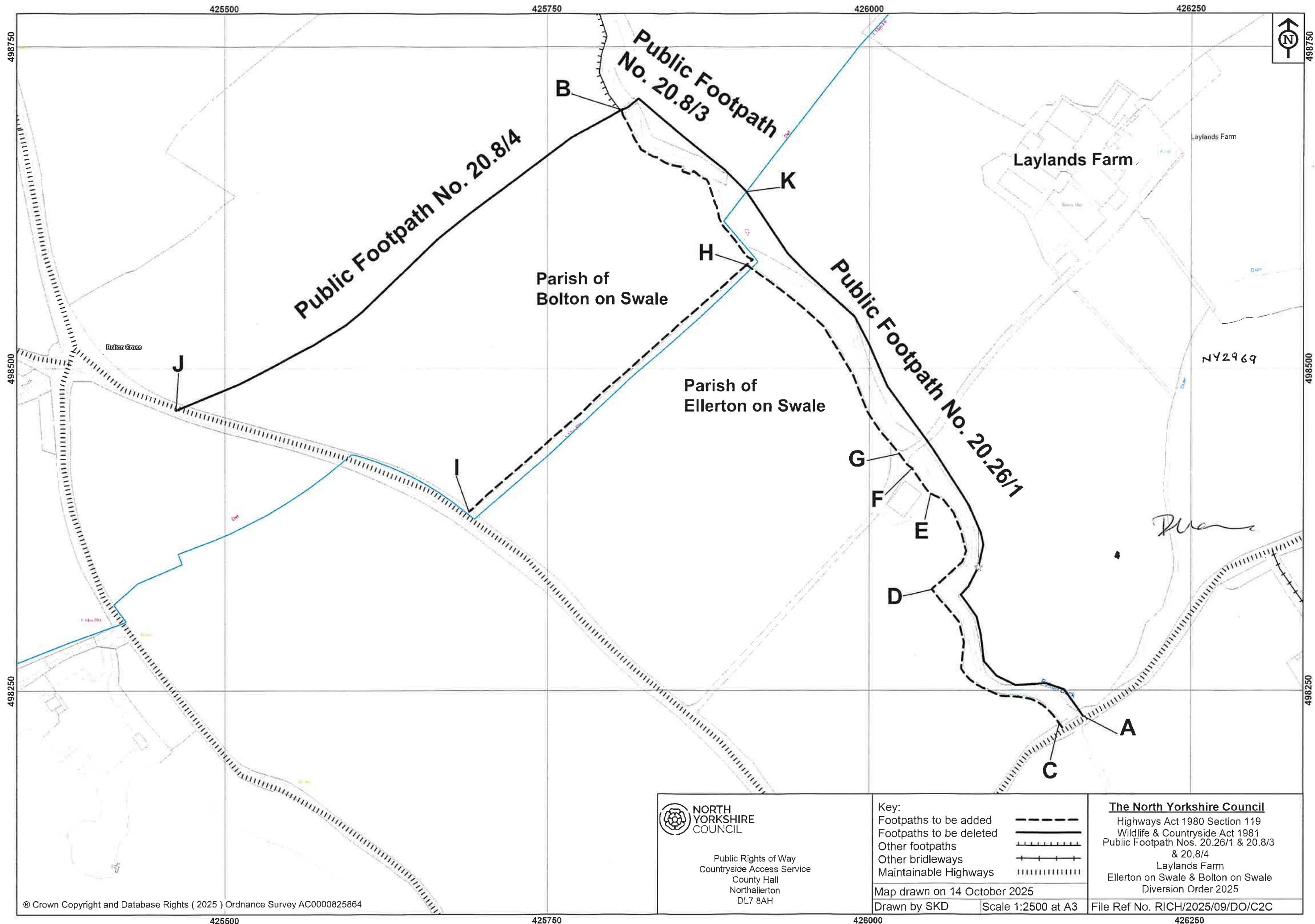

PUBLIC PATH DIVERSION AND
DEFINITIVE MAP AND STATEMENT MODIFICATION ORDER

HIGHWAYS ACT 1980
WILDLIFE AND COUNTRYSIDE ACT 1981

THE NORTH YORKSHIRE COUNCIL

PUBLIC FOOTPATH NOS. 20.26/1 & 20.8/3 & 20.8/4, ELLERTON ON SWALE &
BROMPTON ON SWALE DIVERSION ORDER 2025

THE NORTH YORKSHIRE COUNCIL in exercise of the powers conferred upon it in that behalf hereby confirm the foregoing Order (without any modification) as an Unopposed Order.

IN WITNESS whereof
THE COMMON SEAL of THE NORTH
YORKSHIRE COUNCIL
was hereunto affixed this 12th day December
of 2025
in the presence of:-

