

NORTH YORKSHIRE COUNCIL
TEMPORARY CLOSURE OF PUBLIC FOOTPATH 15.135/15/1
TOCKWITH
EMERGENCY NOTICE NO 36

ROAD TRAFFIC REGULATION ACT 1984 - SECTION 14(2b)
(AS AMENDED)

North Yorkshire Council hereby gives notice that from 11th February 2026 until 3rd March 2026 inclusive, no pedestrian shall proceed along Public Footpath 15.135/15/1 in the Parish of Tockwith between grid references SE44065264 and SE44715225, due to an unsafe bridge. This Emergency closure will be followed by a six month closure until 10th August 2026.

The closure will be put into effect when necessary by means of the erection of notices and signs.

Access for pedestrians to premises will be maintained at all times.

All enquiries to: Customer Services, Tel: 0300 131 2 131

Dated: 11th February 2026

BARRY KHAN
Assistant Chief Executive (Legal and Democratic Services)

OFFICIAL

OFFICIAL

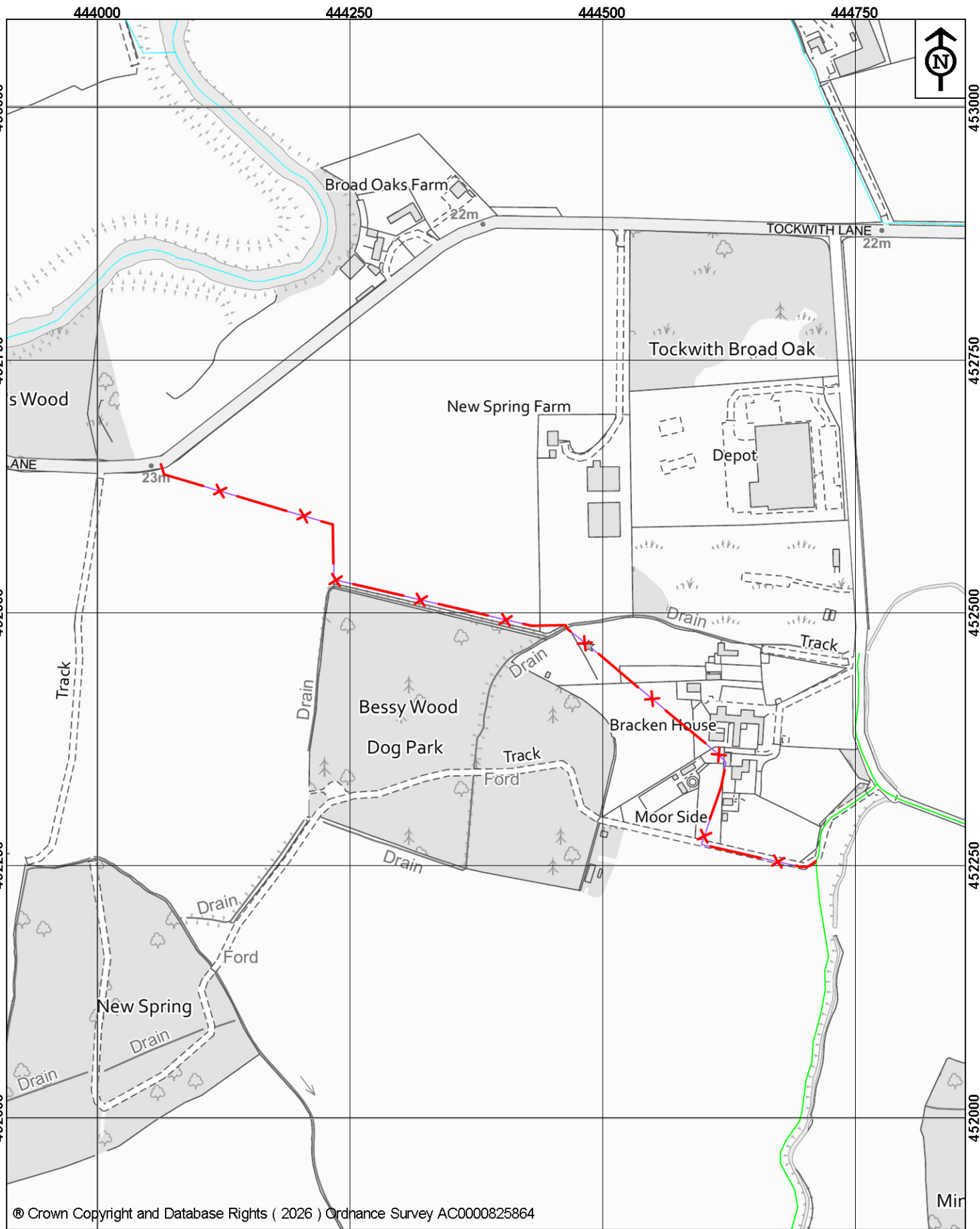

<p>NORTH YORKSHIRE COUNCIL</p> <p>Public Rights of Way Countryside Access Service County Hall Northallerton DL7 8AH</p>	<p>Key:</p> <p>Closed route Public Footpath Public Bridleway</p> <p>Map drawn on 11 February 2026 Drawn by AA</p>	<p>The North Yorkshire Council</p> <p>Temporary closure of Public Footpath 15.135/15/1 in Tockwith</p> <p>Scale 1:5000 File Ref No. 72/15/135/15/1/11/02/2026</p>
--	--	--