

WEST PIER

RENOVATION AND IMPROVEMENT

BUILDING 1

EXISTING BUILDING

The former Harbour Office is a two-storey Arts and Crafts building dating from 1880, later extended by 1910, originally serving as offices for harbour shipping companies. Constructed in red brick with sandstone detailing, it features steep clay-tiled roofs, decorative gables, chimney stacks, and a prominent stone balcony.

Over time, the building has been altered, with the ground floor now used as public toilets and the first floor as offices and studios accessed externally. While many internal and external changes have occurred, some original features and finishes survive, particularly within parts of the first floor, reflecting the building's historic character and evolution.

CHALLENGES

- Weathering of existing brick and stone.
- Unsafe structural elements.
- The existing use of the ground floor for public toilets is not appropriate for a historically significant building.

PROPOSALS

- Repair and stabilise the building - notably the roof, windows and doors.
- Reinstatement of the original fenestration to improve the appearance of the North-East elevation and views of the harbour.
- Retain the historic character.
- Create flexible space for future use, accommodating commercial services.
- Improve resilience to coastal conditions - installing flood resilience measures.
- Relocate the toilets to a new purpose-built facility on the pier.



Building 1 (Google Maps 2025)



Building 1 (Google Maps 2015)



Building 1 (Google Maps 2015)



Building 1 Features - Clock



Building 1 Features - Existing chimney in disrepair



Building 1 Features - Existing weathered stone



Existing North West Elevation



Existing South West Elevation

Existing windows to be reinstated

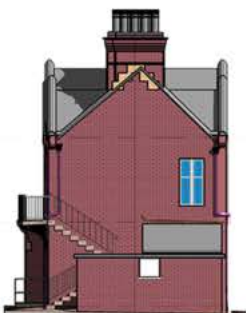

Existing South East Elevation



Existing North East Elevation

