

NORTH YORKSHIRE COUNCIL  
(TEMPORARY PROHIBITION OF PEDESTRIANS)  
PUBLIC FOOTPATH 15.76/1/1, LEATHLEY  
ORDER 2025 NO 509

Road Traffic Regulation Act 1984 – Section 14(1) (as amended)

**NOTICE** is hereby given that the above Order, the effect of which is to prohibit any public access along Public Footpath 15.76/1/1 in the Parish of Leathley between grid references SE22064733 and SE23164730 due to an unsafe bridge has been continued in force for a further six months until 7<sup>th</sup> December 2026 or until the completion of the works (whichever is the earlier), under Section 15(3) of the above Act with the approval of the Secretary of State for Transport.

The further continuation of the closure will be put into effect by notices and signs.

**All enquiries to: Customer Services @ 0300 131 2 131**

Further details can be viewed at:  
<https://www.northyorks.gov.uk/rights-way-public-notices>

Dated: 4<sup>th</sup> June 2026

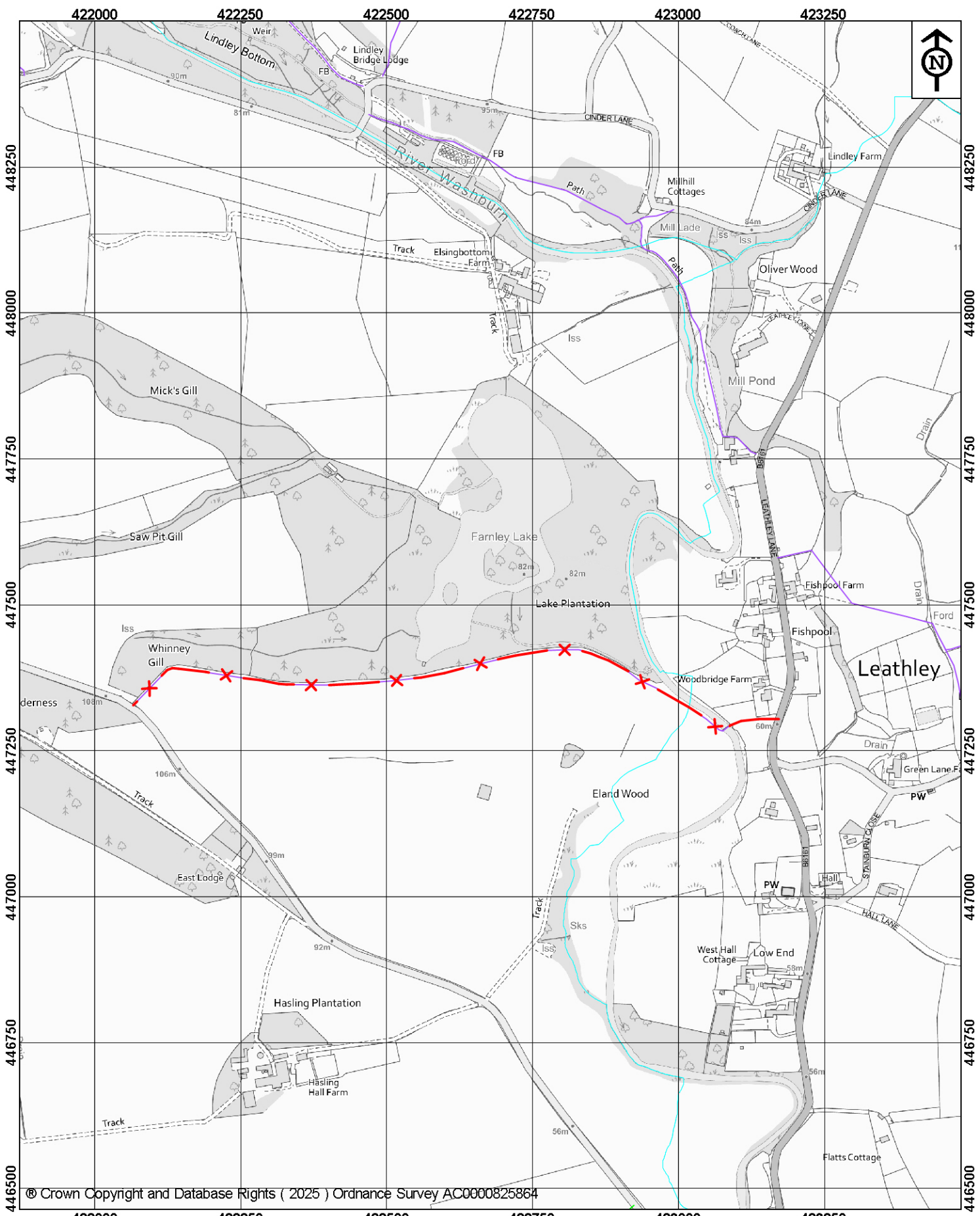

© Crown Copyright and Database Rights ( 2025 ) Ordnance Survey AC0000825864

**NORTH YORKSHIRE COUNCIL**  
 Public Rights of Way  
 Countryside Access Service  
 County Hall  
 Northallerton  
 DL7 8AH

**Key:**  
 Closed route - x - x -  
 Public Footpath —

Map drawn on 8 December 2025  
 Drawn by DS      Scale 1:8500

**The North Yorkshire Council**  
 Temporary closure of  
 Public Footpath 15.76/1/1 in  
 Leathley

File Ref No. 72/15/76/1/1/08/12/25