

**NOTICE OF CONFIRMATION OF A PUBLIC PATH DIVERSION ORDER**

**HIGHWAYS ACT 1980**

**NORTH YORKSHIRE COUNTY COUNCIL**

**FOOTPATH NO.10.33/7 HOME FARM, CRAYKE, DIVERSION ORDER 2018**

On 04 June 2018, North Yorkshire County Council confirmed the above Order made under Section 119 of the Highways Act 1980.

The effect of the Order as confirmed is to divert public footpath no. 10.33/7 running generally southwest from GR SE 5623 7127 to GR SE 5607 7093 will be diverted onto a new route via GR SE 5631 7127 and GR SE 5623 7122. The new route will be 2.5 metres wide throughout on a natural surface.

A copy of the Order as confirmed and the Order Map have been placed and may be seen free of charge during normal office hours at Easingwold Information Centre, North Yorkshire until 27 July 2018. Copies of the Order and Map may be purchased from Waste & Countryside Services, North Yorkshire County Council, County Hall, Northallerton, North Yorkshire, DL7 8AD (tel: 01609 532512) at a cost of £2, or can be downloaded free from our website [www.northyorks.gov.uk/pathnotices](http://www.northyorks.gov.uk/pathnotices).

The Order comes into force as from 15<sup>th</sup> June 2018, but if a person aggrieved by the Order wants to question its validity, or that of any provision contained in it, on the ground that it is not within the powers of the Highways Act 1980 as amended, or on the ground that any requirement of the Act, as amended, or of any regulation made under the Act has not been complied with in relation to the Order, he or she may, under Paragraph 2 of Schedule 2 to the Act as applied by Paragraph 5 of Schedule 6 to the Act, within six weeks from 15th June 2018, make an application to the High Court.

Dated: 15 June 2018

Barry Khan  
Assistant Chief Executive  
(Legal and Democratic Services)  
County Hall  
Northallerton  
North Yorkshire  
DL7 8AH



**PUBLIC PATH DIVERSION ORDER**

**HIGHWAYS ACT 1980**

**NORTH YORKSHIRE COUNTY COUNCIL**

**FOOTPATH NO.10.33/7 HOME FARM, CRAYKE  
DIVERSION ORDER 2018**

Barry Khan  
Assistant Chief Executive  
(Legal and Democratic Services)  
County Hall  
Northallerton  
North Yorkshire  
DL7 8AH

**PUBLIC PATH DIVERSION ORDER**

**HIGHWAYS ACT 1980**

**NORTH YORKSHIRE COUNTY COUNCIL**

**FOOTPATH NO.10.33/7 HOME FARM, CRAYKE**  
**DIVERSION ORDER 2018**

This Order is made by North Yorkshire County Council ("the Authority") under Section 119 of the Highways Act 1980 ("the 1980 Act") because it appears to the Authority that in the interests of the owner of the land crossed by the footpath described in Paragraph 1 of this Order it is expedient that the line of the path should be diverted.

Mr Peter Cliffe of Home Farm, Crayke Estates has agreed to defray any compensation which becomes payable in consequence of the coming into force of this Order and any expenses which are incurred in bringing the new site of the path into a fit condition for use by the public.

Hambleton District Council and Crayke Parish Council have been consulted as required by Section 120(2) of the 1980 Act.

BY THIS ORDER:

1. The public right of way over the land situated at Home Farm, Crayke described in Part 1 of the Schedule to this Order and shown by a bold continuous line on the map contained in this Order shall be stopped up after 28 days from the date of confirmation of this order.
2. There shall at the end of 28 days from the date of confirmation of this Order be a public footpath over the land situated at Home Farm, Crayke described in Part 2 of the Schedule to this Order and shown by a bold broken line on the map contained in this Order.

THE COMMON SEAL of NORTH  
YORKSHIRE COUNTY COUNCIL  
was  
hereunto affixed this  
day of 23<sup>rd</sup> April 2018 «Year»  
in the presence of:-



**AUTHORISED  
SIGNATORY**

SCHEDULE

PART 1

DESCRIPTION OF SITE OF EXISTING FOOTPATH

<u>Section of Footpath as shown on the attached map</u>	<u>Position</u>	<u>Width</u>
Marked by a bold continuous line and shown as A – B on the attached plan	Commences at Grid Reference 45623 47127, Point A and runs south south west for approximately 370 metres to Grid Reference 45607 47093, Point B.	

PART 2

DESCRIPTION OF SITE OF NEW FOOTPATH

<u>Section of Footpath as shown on the attached map</u>	<u>Position</u>	<u>Width</u>
Marked by a bold broken line and shown as A - E – D – C – B on the attached plan.	Commences at Grid Reference 45623 47127, Point A and runs generally for approximately 85 metres to Grid Reference 45631 47127, Point E then continues south south west for approximately 170 metres to a farm track at Grid Reference 45623 47112, Point D then continues across the track for approximately 4.5 metres to Grid Reference 45623 47111, Point C then continues generally south south west for approximately 240 metres to re-join existing path at Grid Reference 45607 47093, Point B.	Point A – E - D 2.5 metres  Point C – B 2.5 metres

**PUBLIC PATH DIVERSION ORDER**

**HIGHWAYS ACT 1980**

**NORTH YORKSHIRE COUNTY COUNCIL**

**FOOTPATH No. 10.33/7, HOME FARM, CRAYKE,**  
**DIVERSION ORDER 2018**

NORTH YORKSHIRE COUNTY COUNCIL in exercise of the powers conferred upon it in that behalf hereby confirm the foregoing Order (without any modification) as an Unopposed Order.

IN WITNESS whereof  
THE COMMON SEAL of NORTH  
YORKSHIRE COUNTY COUNCIL  
was  
hereunto affixed this 4<sup>th</sup>  
day of June 2018 «Year»  
in the presence of:-

20576



*W. Coder*

**AUTHORISED  
SIGNATORY**

456250



471250

471250

471000

471000

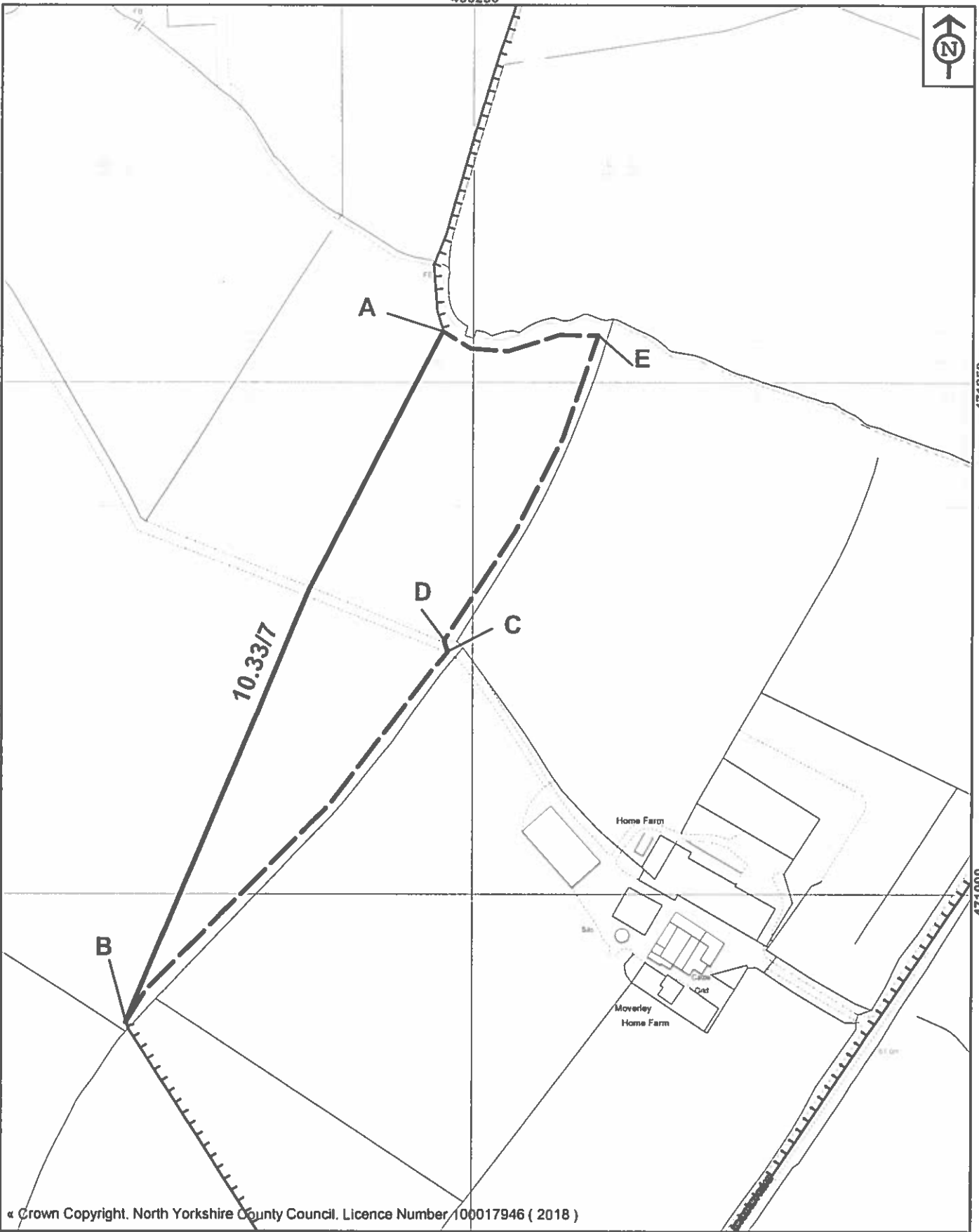





© Crown Copyright. North Yorkshire County Council. Licence Number 100017946 ( 2018 )

456250



**North Yorkshire  
County Council**

Public Rights of Way  
Waste and Countryside Services  
County Hall  
Northallerton  
DL7 8AH

Key:  
 Footpath to be added        
 Footpath to be deleted        
 Other footpaths        
 Maintainable Highways      

**North Yorkshire County Council**

Highways Act 1980 Section 119

Footpath No. 10.33/17  
Home Farm, Crayke  
Diversion Order 2018

Map drawn on 17 April 2018

Drawn by ML

Scale 1:2500

File Ref No. HAM/2017/17/DO

