

Notice of the Making of a Definitive Map Modification Order, North Yorkshire County Council, Wildlife & Countryside Act 1981, The Eastern Part of the County of the Former North Riding of Yorkshire, Definitive Map and Statement, Public Footpath Nos. 30.19/34, 30.19/35, 30.19/36 & 30.19/37, Weaponness Valley Close and Oriel Close to Queen Margaret's Road and Seamer Road, Scarborough, Modification Order 2019

The above Order, made on 28/11/19, if confirmed as made, will modify the definitive map and statement for the area by adding the following four footpaths, all as shown on the Order Plan:

Footpath 30.19/34, commencing at the southern end of Oriel Close at Grid Reference TA 0358 8716 and running south-west along a snicket for approximately 47 metres to TA 0355 8713, then generally south-west across a field for approximately 162 metres to TA 0345 8701, then generally south for approximately 278 metres, entering the Industrial Estate at TA 0341 8674, continuing south along a footway for approximately 357 metres to join Queen Margaret's Road opposite The Mere at TA 0345 8644. **Footpath 30.19/35**, commencing at its junction with Footpath 30.19/34 at TA 0339 8646, and running generally west along an access road for approximately 48 metres to TA 0335 8645, then south for approximately 14 metres, climbing a flight of steps to its junction with Queen Margaret's Road at TA 0335 8643. **Footpath 30.19/36**, commencing at its junction with Weaponness Valley Close at TA 0352 8716 and running generally south-west for approximately 21 metres to a stile at TA 0351 8714, then generally south-south-west for approximately 104 metres to its junction with Footpath 30.19/34 in the field at TA 0347 8704. **Footpath 30.19/37**, Commencing at its junction with Footpath 30.19/34 at TA 0344 8699 and running west for approximately 93 metres to TA 0334 8699, then south-south-west for approximately 31 metres to TA 0332 8697, then west for approximately 70 metres to its junction with Seamer Road at TA 0326 8697. A copy of the Order as made and the Order Map may be seen free of charge during normal office hours at Scarborough Library, Vernon Road, Scarborough YO11 2NN until 26/03/20. Copies of the Order and Map may be purchased from Waste & Countryside Services, County Hall, Northallerton, North Yorkshire, DL7 8AD (tel: 01609 532512) at a cost of £2.00, or can be downloaded free from our website www.northyorks.gov.uk/pathnotices. Any representation or objection relating to the Order must be sent in writing to Andrew Hunter, Definitive Map Team, County Hall, Northallerton, North Yorkshire, DL7 8AD, no later than 26/03/20, stating the grounds on which it is made. Please note that objections/representations cannot be treated as confidential and may come into the public domain. Copies of any objections or representations received may be disclosed to interested parties, including the Planning Inspectorate where the case is referred to it for determination. If no representations or objections are duly made to the Order, or to any part of it, or if any so made are withdrawn, North Yorkshire County Council, instead of submitting the Order to the Secretary of State or part of it if the Authority has by notice to the Secretary of State so elected under paragraph 5 of Schedule 15 to the Wildlife and Countryside Act 1981 may itself confirm the Order or that part of the Order. If the Order is submitted to the Secretary of State for the Environment, in whole or in part, any representations or objections which have been duly made and not withdrawn will be sent with it.

Dated:13/02/20

Barry Khan, Assistant Chief Executive, Legal and Democratic Services

NORTH YORKSHIRE COUNTY COUNCIL

WILDLIFE AND COUNTRYSIDE ACT 1981

**THE EASTERN PART OF THE COUNTY OF THE FORMER NORTH RIDING OF
YORKSHIRE DEFINITIVE MAP AND STATEMENT**

**PUBLIC FOOTPATH NOS. 30.19/34, 30.19/35, 30.19/36 & 30.19/37, WEAPONNESS VALLEY
CLOSE AND ORIEL CLOSE TO QUEEN MARGARET'S ROAD AND SEAMER ROAD,
SCARBOROUGH
MODIFICATION ORDER 2019**

Barry Khan
Assistant Chief Executive
(Legal and Democratic Services)
County Hall
Northallerton
North Yorkshire
DL7 8AH

NORTH YORKSHIRE COUNTY COUNCIL

WILDLIFE AND COUNTRYSIDE ACT 1981

**THE EASTERN PART OF THE COUNTY OF THE FORMER NORTH RIDING OF YORKSHIRE
DEFINITIVE MAP AND STATEMENT**

**PUBLIC FOOTPATH NOS. 30.19/34, 30.19/35, 30.19/36 & 30.19/37, WEAPONNESS VALLEY CLOSE
AND ORIEL CLOSE TO QUEEN MARGARET'S ROAD AND SEAMER ROAD, SCARBOROUGH
MODIFICATION ORDER 2019**

This order is made by North Yorkshire County Council under Section 53(2)(b) of the Wildlife and Countryside Act 1981 ("the Act") because it appears to that authority that the Eastern Part of the County of the Former North Riding of Yorkshire Definitive Map and Statement require modification in consequence of the occurrence of an event specified in Section 53(3)(c)(i), namely the discovery by the authority of evidence which (when considered with all other relevant evidence available to them) shows that a right of way which is not shown in the map and statement subsists or is reasonably alleged to subsist over land in the area to which the map relates, being a right of way such that the land over which the right subsists is a public path, a restricted byway or, subject to section 54A, a byway open to all traffic.

The authority has consulted with every local authority whose area includes the land to which the Order relates. North Yorkshire County Council hereby order that:-

1. For the purpose of this Order the relevant date is 5 November 2019.
2. The Eastern Part of the County of the Former North Riding of Yorkshire Definitive Map and Statement shall be modified as described in Part I and Part II of the Schedule and shown on the map attached to the Order.
3. This Order shall take effect on the date it is confirmed and may be cited as the Public Footpath Nos. 30.19/34, 30.19/35, 30.19/36 & 30.19/37, Weaponness Valley Close and Oriel Close to Queen Margaret's Road and Seamer Road, Scarborough Modification Order 2019.

**THE COMMON SEAL of NORTH
YORKSHIRE COUNTY COUNCIL**

was hereunto affixed this 28 day of

November 2019 in the presence of:-

W. Cooley
**AUTHORISED
SIGNATORY**



SCHEDULE

PART I

Modification of Definitive Map Description of path or way to be added

<u>Section of Footpath as shown on the attached map</u>	<u>Description</u>
<p>Footpath 30.19/34 Indicated on the Order map and marked as A-B-C-D-E-F-G-H-I-J</p>	<p>Commences at the southern end of Oriel Close at Grid Reference 50358 48716 Point A and runs south-west for approximately 47 metres to Grid Reference 50355 48713, Point B, then south-west for approximately 118 metres to a path junction in the field at Grid Reference 50347 48704, Point C, then south-south-west across the same field for approximately 44 metres to Grid Reference 50345 48701, Point D, continuing south-south-west for approximately 27 metres to a path junction at Grid Reference 50344 48699, Point E, then generally south for approximately 251 metres to a gap at Grid Reference 50341 48674, Point F then south along a footway on Queen Margaret's Road Industrial Estate for approximately 279 metres to Grid Reference 50339 48646, Point G, then south-south-east for approximately 19 metres crossing the access road to Grid Reference 50340 48645, Point H, then east along a footway for approximately 44 metres to Grid Reference 50345 48645, Point I, then south for approximately 15 metres to its junction with Queen Margaret's Road at Grid Reference 50345 48644, Point J. Width of path varying from 1.8 metres to 2 metres.</p>
<p>Footpath 30.19/35 Indicated on the Order map and marked as G-K-L</p>	<p>Commences at its junction with Footpath 30.19/34 at Grid Reference 50339 48646, Point G and runs generally west along an access road for approximately 48 metres to Grid Reference 50335 48645, Point K, then south for approximately 14 metres, climbing a flight of steps to its junction with Queen Margaret's Road at Grid Reference 50335 48643, Point L. Width of path 1.2 metres to 2.0 metres.</p>
<p>Footpath 30.19/36 Indicated on the Order map and marked as M-N-C</p>	<p>Commences at its junction with Weaponness Valley Close at Grid Reference 50352 48716, Point M and runs generally south-west for approximately 21 metres to a stile at Grid Reference 50351 48714, Point N, then generally south-south-west for approximately 104 metres to its junction with footpath 30.19/34 at Grid Reference 50347 48704, Point C. Width of path 1.7 metres to 2.0 metres.</p>
<p>Footpath 30.19/37 Indicated on the Order map and marked as E-O-P-Q,</p>	<p>Commences at its junction with Footpath 30.19/34 at Grid Reference 50344 48699, Point E and runs west for approximately 93 metres to Grid Reference 50334 48699, Point O, then south-south-west for approximately 31 metres to Grid Reference 50332 48697, Point P then west for approximately 70 metres, passing under a railway bridge to its junction with Seamer Road at Grid Reference 50326 48697, Point Q. Width of path 2.0 metres.</p>

PART II

Modification of Definitive Statement
Variation of Particulars of path or way

Path No.	Grid Reference End Points	Description	Nature of Surface	Length (Km)	Width (M)	Lawful Obstructions & Conditions
Footpath 30.19/34	50358 48716 (Start) 50345 48644 (End)	Commences at the southern end of Oriel Close at Grid Reference 50358 48716 and runs south-west for approximately 47 metres to Grid Reference 50355 48713, then south-west across a field for approximately 118 metres to a path junction in the field at Grid Reference 50347 48704, then south-south-west across the same field for approximately 44 metres to Grid Reference 50345 48701, continuing south-south-west for approximately 27 metres to a path junction at Grid Reference 50344 48699, then generally south for approximately 251 metres to a gap at Grid Reference 50341 48674, then south along a footway on Queen Margaret's Road Industrial Estate access road for approximately 279 metres to Grid Reference 50339 48646, then south-south-east for approximately 19 metres, crossing the industrial estate access road to Grid Reference 50340 48645, then east along a footway for approximately 44 metres to Grid Reference 50345 48645, then south for approximately 15 metres to its junction with Queen Margaret's Road at Grid Reference 50345 48644.	Compacted earth	0.047	Varying from 1.8m to 2.0m	A stile at 50355 48713
			Grass	0.162		2.0
			Crushed stone	0.027	2.0	A gap of 1m at 50341 48674
			Grass and compacted earth	0.251	2.0	
			Tarmacadam	0.342	1.8	
			Compacted earth	0.015	2.0	
			Total	0.844		
Footpath 30.19/35	50339 48646 (Start) 50335 48643 (End)	Commences at its junction with Footpath 30.19/34 at Grid Reference 50339 48646 and runs generally west along an access road for approximately 48 metres to Grid Reference 50335 48645, then south for approximately 14 metres, climbing a flight of steps to its junction with Queen Margaret's Road at Grid Reference 50335 48643.	Tarmacadam	0.048	2.0	Concrete steps from 50335 48645 to 50335 48643.
			Concrete	0.014	1.2	
			Total	0.062		

Path No.	Grid Reference End Points	Description	Nature of Surface	Length (Km)	Width (M)	Lawful Obstructions & Conditions
Footpath 30.19/36	50352 48716 (Start) 50347 48704 (End)	Commences at its junction with Weaponness Valley Close at Grid Reference 50352 48716 and runs generally south-west for approximately 21 metres to a stile at Grid Reference 50351 48714, then generally south-south-west for approximately 104 metres to its junction with Footpath 30.19/34 at Grid Reference 50347 48704	Compacted earth. Grass	0.021	1.7	A stile at 50351 48714.
				0.104	2.0	
				Total 0.125		
Footpath 30.19/37	50344 48699 (Start) 50326 48697 (End)	Commences at its junction with Footpath 30.19/34 at Grid Reference 50344 48699 and runs west for approximately 93 metres to Grid Reference 50334 48699, then south-south-west for approximately 31 metres to Grid Reference 50332 48697, then west for approximately 70 metres passing under a railway bridge to its junction with Seamer Road at Grid Reference 50326 48697.	Crushed stone Tarmacadam	0.062	2.0	None.
				0.132	2.0	
				Total 0.194		

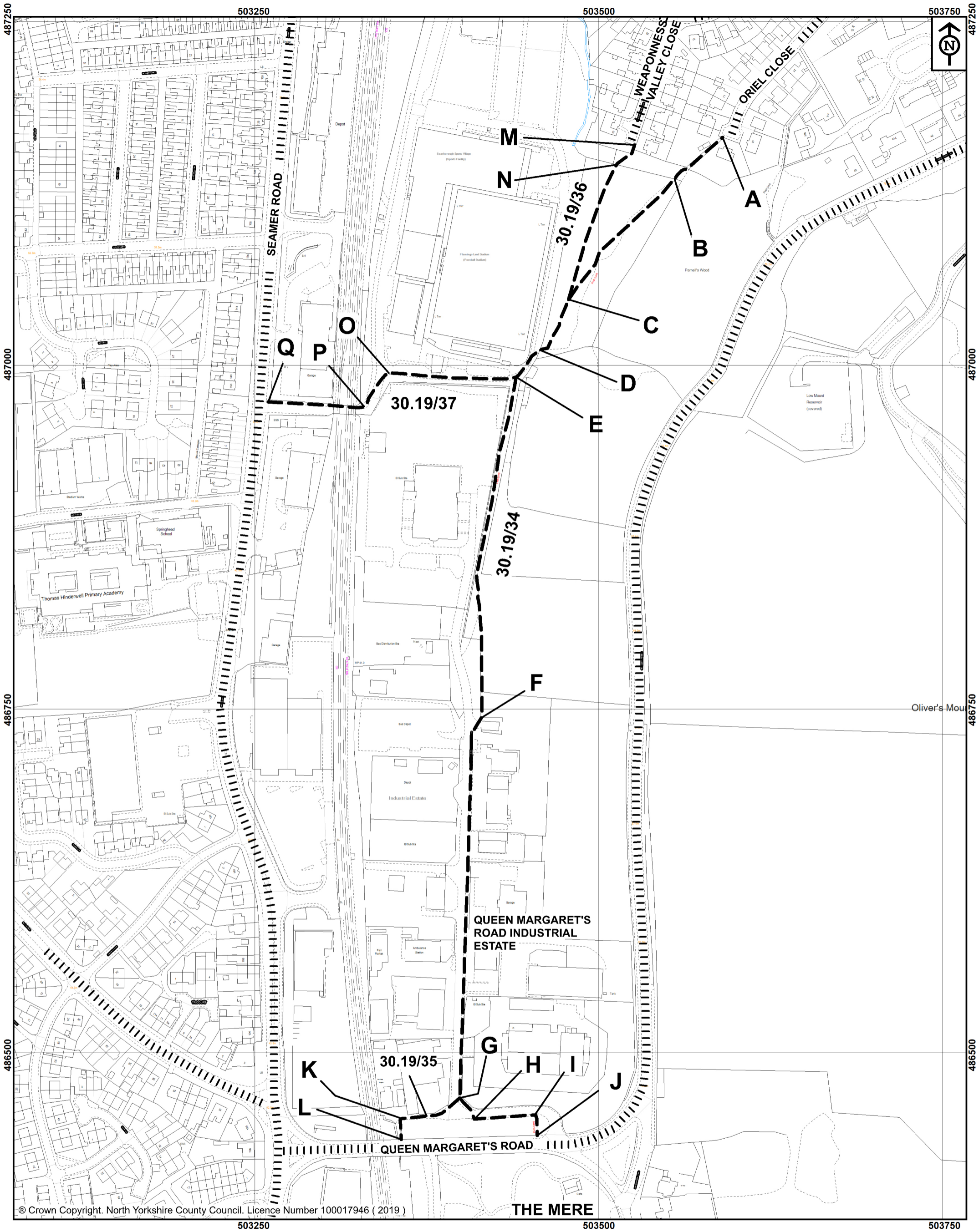

© Crown Copyright. North Yorkshire County Council. Licence Number 100017946 (2019)



**North Yorkshire
County Council**

Public Rights of Way
Waste and Countryside Services
County Hall
Northallerton
DL7 8AH

Key:

Footpath to be recorded

Maintained Highways

Map drawn on 8 November 2019

Drawn by AWH

Scale 1:2500

North Yorkshire County Council

Wildlife and Countryside Act 1981 Section 53

PUBLIC FOOTPATH NOS. 30.19/34, 30.19/35, 30.19/36 & 30.19/37,
WEAPONNESS VALLEY CLOSE AND ORIEL CLOSE TO QUEEN
MARGARET'S ROAD AND SEAMER ROAD, SCARBOROUGH
MODIFICATION ORDER 2019

File Ref No. SCAR/2017/04/DMMO