

Learn about what it means to live in a Conservation Area and why one is being proposed for our village. Parish Councillors will also be available at the Village Hall to discuss the proposal with residents between 1pm and 3pm on 28 May.

We invite you to complete a short questionnaire to help us understand your views and to gather information on what you feel needs to be done to improve the appearance and character of Sessay as well as identify key features and buildings of value.

The purpose of a Conservation Area is to acknowledge significant historic places and to cherish the local distinctiveness of areas that are valued by communities. Hambleton District Council has policies in its Local Plan to manage Conservation Areas and to ensure that new developments harmonises and respects their character and appearance. There are currently 53 Conservation Areas in the district.

The proposed Conservation Area boundary for Sessay is indicated overleaf, it only covers the southern side of the village. The proposal was first set out in the **Sessay Community Plan 2014** and follows a statutory appraisal process using historic, architectural and archaeological evidence provided locally by Sessay's Community History Project.

The Draft Conservation Area Appraisal and Management Plan Supplementary Planning Document (SPD) can be downloaded at: www.northyorks.gov.uk/planning-and-conservation/planning-policy/planning-policy-your-local-area/hambleton-planning-policy/hambleton-local-plan

The focus is around Little Sessay and William Butterfield's church and school. The core area extends to include the former Rectory and elements of the surviving medieval landscape associated with the site of Sessay's medieval manor (now incorporating three

farmsteads, Rooper Hill Farm, Church Farm and Village Farm).

We would like your views on two potential boundary extensions to the core area running into centre of the village, most residents affected by this proposal live in these areas:

Extension 1: A distinct range of 8 estate cottages, indicated on the 1858 Dawney Estate Plan, to include, New Cottage, Hazel Cottage, The Rowans, The Old Post Office, Lanreath, Pear Tree Cottage, The Old Cottage and Apple Tree Cottage.

Extension 2: A Western boundary extension from Village Farm, North to include Churchward House, Plum Tree Cottage, Oval View and Downe House.

Following public consultation, questionnaires will be considered and the Draft Conservation Area Appraisal and Management Plan amended. Hambleton District Council is likely to then meet to decide whether to designate a Conservation Area in Sessay on the 5 September.

Your views are important. The purpose of the exercise is to formally recognise and enhance Sessay's unique character and appearance for current and future generations, ensuring that new development is locally distinctive and well designed.

For more information

Call **01609 779977**

Email planningpolicy@hambleton.gov.uk

Visit hambleton.gov.uk/localplan



This information is available in alternative formats and languages

Have your say... ...on a proposed Conservation Area for Sessay

Hambleton District Council and Sessay Parish Council invite you to a public meeting

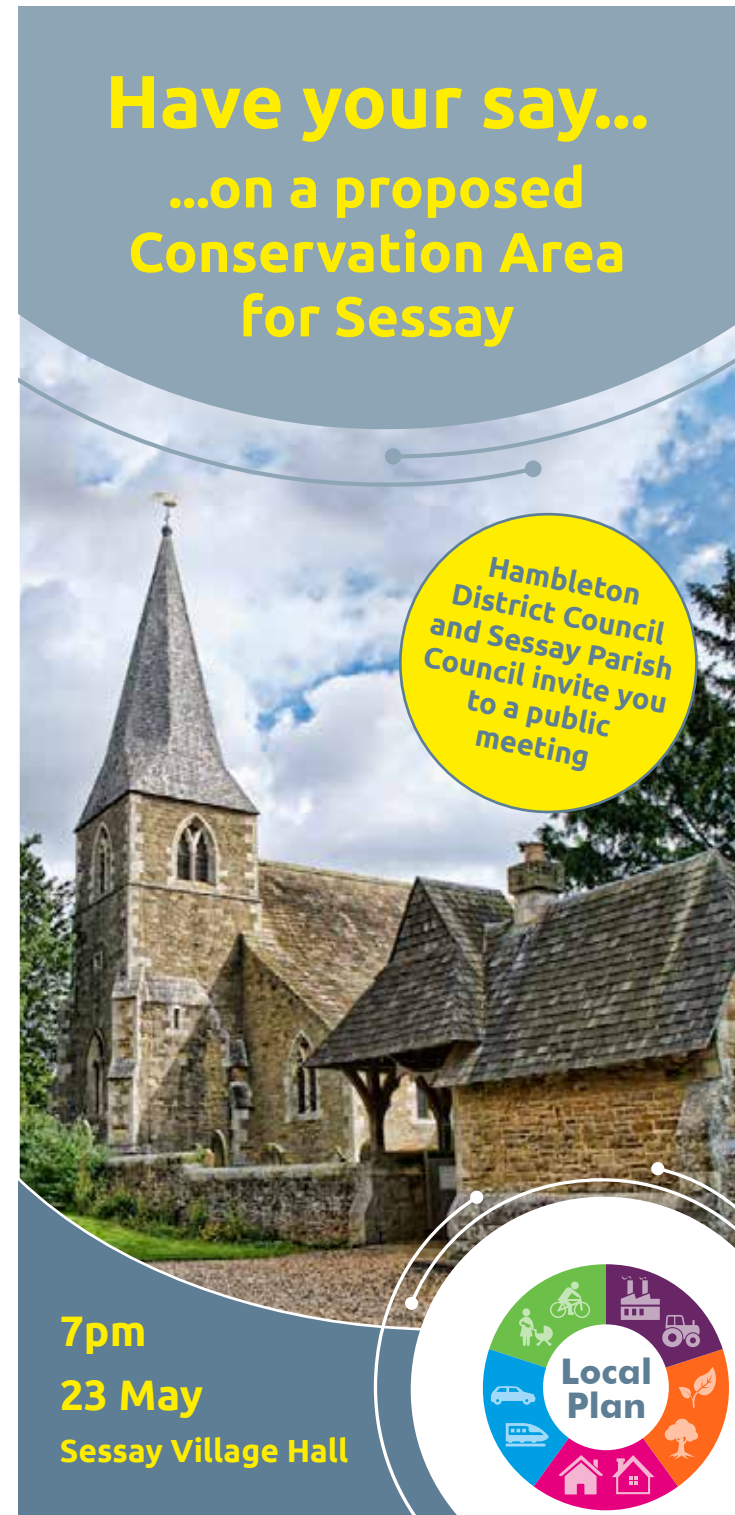

7pm
23 May
Sessay Village Hall



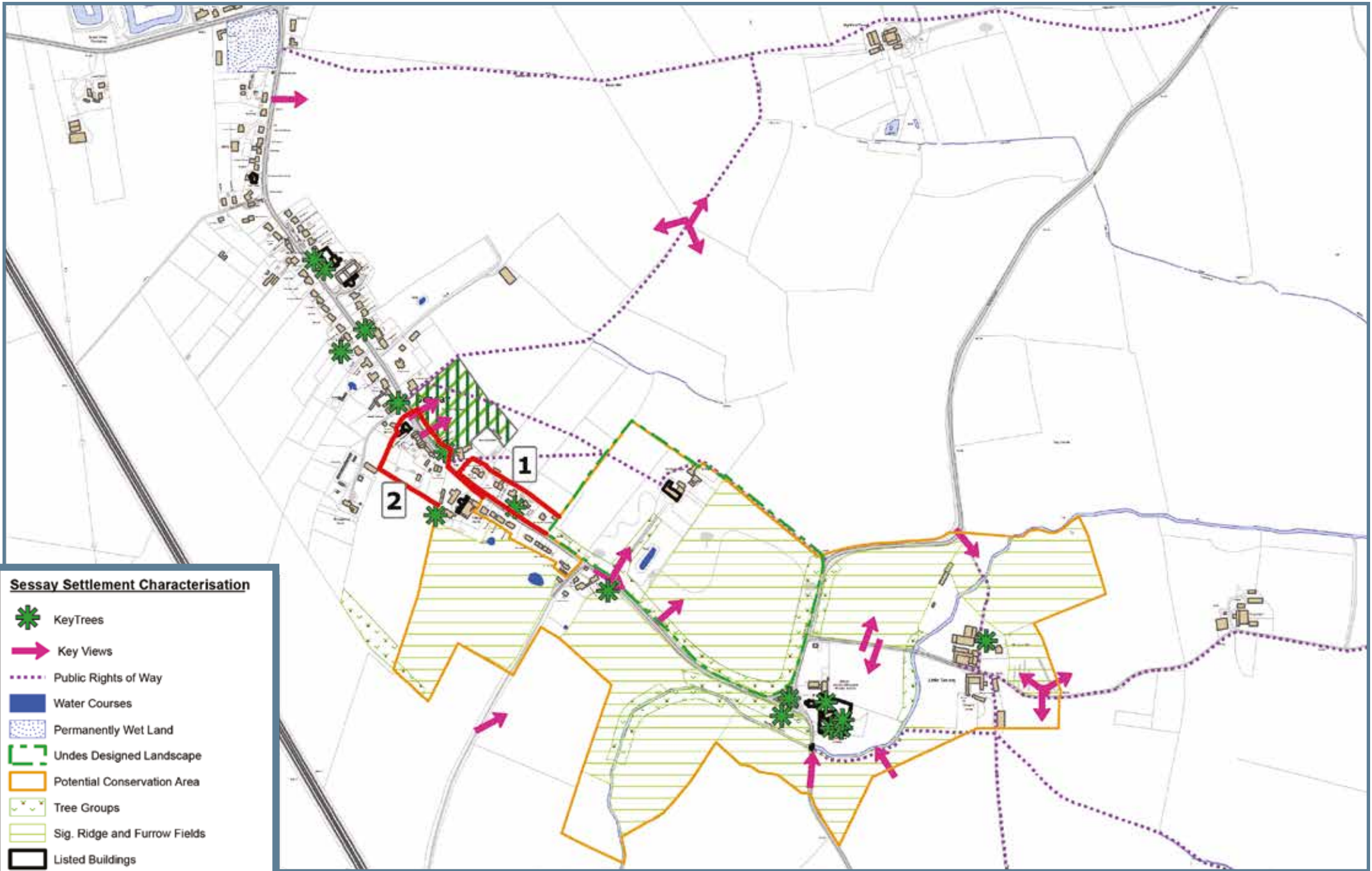

Sessay Settlement Characterisation

-  Key Trees
-  Key Views
-  Public Rights of Way
-  Water Courses
-  Permanently Wet Land
-  Undes Designed Landscape
-  Potential Conservation Area
-  Tree Groups
-  Sig. Ridge and Furrow Fields
-  Listed Buildings
-  Key Open Spaces
-  Local Green Space Designation
-  Proposed Boundary Extensions



© Crown copyright [and database rights] 2017 OS 100018555.
 Copyright © and Database rights Environment Agency 2010. All rights reserved.
 Some of the information within the Flood Map is based in part on digital spatial data licensed from the Centre for Ecology and Hydrology © NERC.

HAMBLETON
DISTRICT COUNCIL
 Civic Centre, Stone Cross, Northallerton DL6 2UJ
 Telephone: 01609 779977 Fax: 01609 767228